

301  Pag 301	302  Pag 301	305  Pag 302	306  Pag 302	307  Pag 303	308  Pag 303
309  Pag 304	310  Pag 304	311  Pag 305	312  Pag 305	398  Pag 306	398  Pag 306
313  Pag 307	314  Pag 307	314  Pag 308	315  Pag 308	316  Pag 309	317  Pag 309
317  Pag 309	318  Pag 309	319  Pag 310	320  Pag 310	321  Pag 311	322  Pag 311
323  Pag 311	324  Pag 312	325  Pag 312	326  Pag 312	327  Pag 312	328  Pag 313
329  Pag 313	330  Pag 313	390  Pag 313	392  Pag 314	393  Pag 314	336  Pag 314
394  Pag 315	341  Pag 315	331  Pag 316	345  Pag 316	337  Pag 317	338  Pag 317
339  Pag 317	349  Pag 318	350  Pag 318	351  Pag 318	352  Pag 318	347  Pag 319

348  Pag 319	346  Pag 319	356  Pag 320	357  Pag 320	335  Pag 321	358  Pag 322
364  Pag 322	359  Pag 323	365  Pag 323	360  Pag 324	366  Pag 324	361  Pag 325
367  Pag 325	366  Pag 326	367  Pag 326	364  Pag 327	365  Pag 327	395  Pag 328
362  Pag 328	358  Pag 328	333  Pag 328	353  Pag 329	354  Pag 329	355  Pag 329
363  Pag 330	396  Pag 331	363  Pag 332	199  Pag 333	368  Pag 334	369  Pag 334
370  Pag 335	371  Pag 335	372  Pag 336	373  Pag 336	383  Pag 337	384  Pag 337
385  Pag 338	386  Pag 338	397  Pag 338	374  Pag 339	375  Pag 339	377  Pag 340
378  Pag 340	379  Pag 341	380  Pag 341	381  Pag 342	382  Pag 342	376  Pag 343
376  Pag 343	376  Pag 343	391  Pag 344	387  Pag 345	388  Pag 345	

Materiale / Material / Materialien:

Supporto: PA Support: PA Halter: PA

Volantino: PA+ottone nichelato Knob: PA+nickel plated brass Sterngriff: PA+ Messing vernickelt

Tirante: Acciaio inox Eyebolt: Stainless steel Augenschraube: Edelstahl

301-302

Componenti / Conveyor components / Komponenten

301 Supporto laterale -piccolo- Side bracket -small- / Geländerhalter -klein-

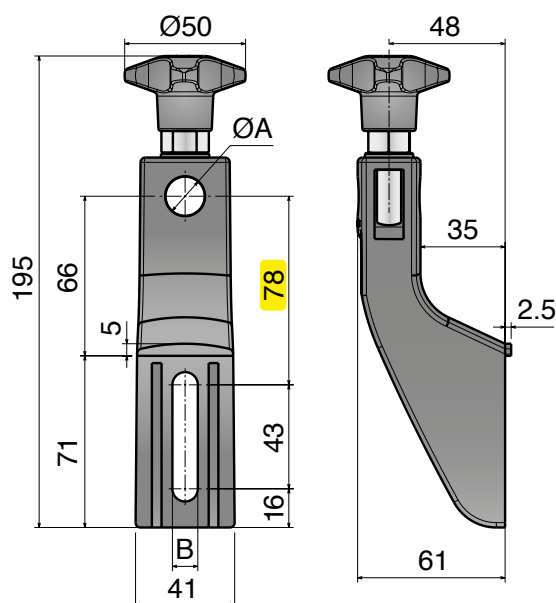

Part	Article-Nr.	ØA	B
301	30101	12	9
301	30105	14	9
301	30102	16	9
301	30103	12	10,5
301	30106	14	10,5
301	30104	16	10,5

302 Supporto laterale -piccolo-, volantino alto Side bracket -small- high knob / Geländerhalter -klein- hoher Sterngriff

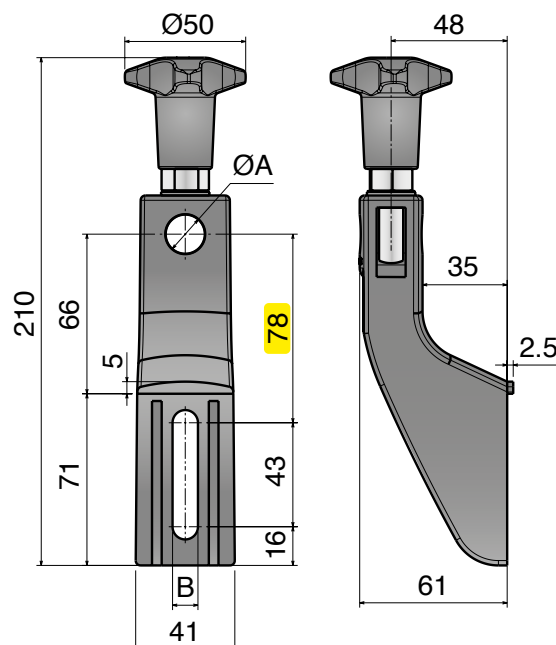

Part	Article-Nr.	ØA	B
302	30201	12	9
302	30205	14	9
302	30202	16	9
302	30203	12	10,5
302	30206	14	10,5
302	30204	16	10,5

305 Supporto laterale -medio- Side bracket -medium- / Geländerhalter -medium-

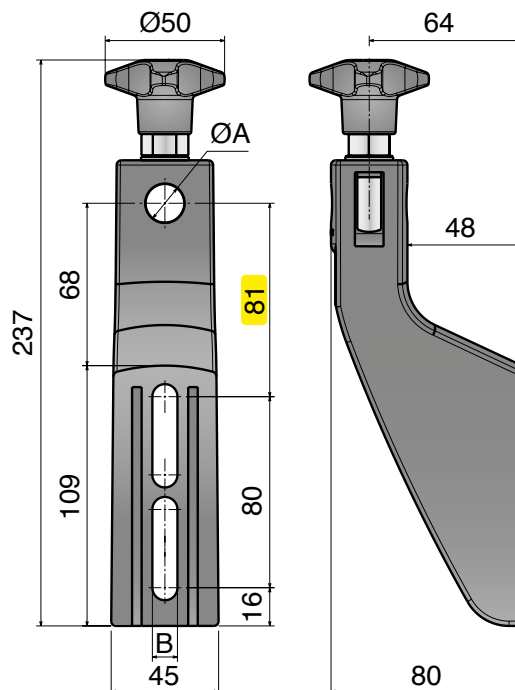

Part	Article-Nr.	ØA	B
305	30501	12	9
305	30505	14	9
305	30502	16	9
305	30503	12	10,5
305	30506	14	10,5
305	30504	16	10,5

306 Supporto laterale -medio-, volantino alto Side bracket -medium-, high knob / Geländerhalter -medium-, hoher Sterngriff

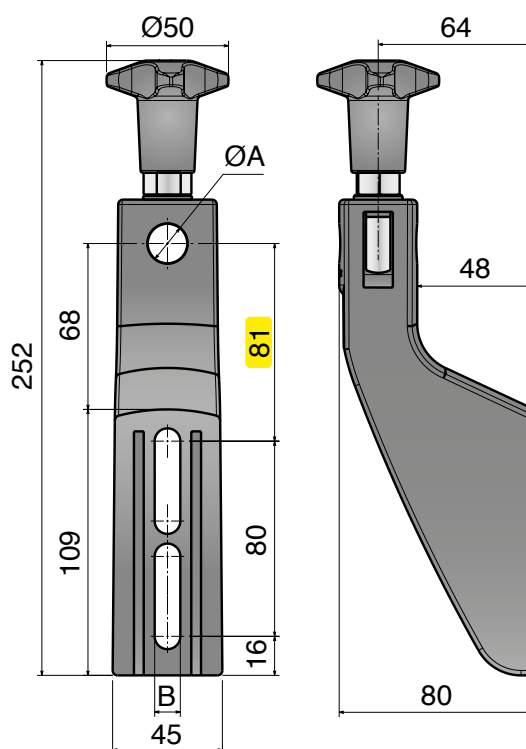

Part	Article-Nr.	ØA	B
306	30601	12	9
306	30605	14	9
306	30602	16	9
306	30603	12	10,5
306	30606	14	10,5
306	30604	16	10,5

307

Supporto laterale -medio-, orientabile

Side bracket -medium-, adjustable / Geländerhalter -medium-, einstellbar

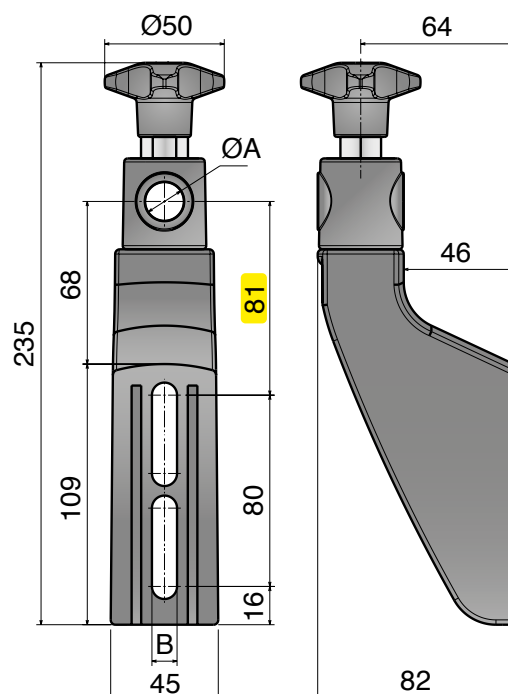

Part	Article-Nr.	ØA	B
307	30701	12	9
307	30705	14	9
307	30702	16	9
307	30703	12	10,5
307	30706	14	10,5
307	30704	16	10,5
307	30709	bracket	9
307	30710	bracket	10,5

308

Supporto laterale -medio-, orientabile INOX

Side bracket -medium-, adjustable SS / Geländerhalter -medium-, einstellbar Edelstahl

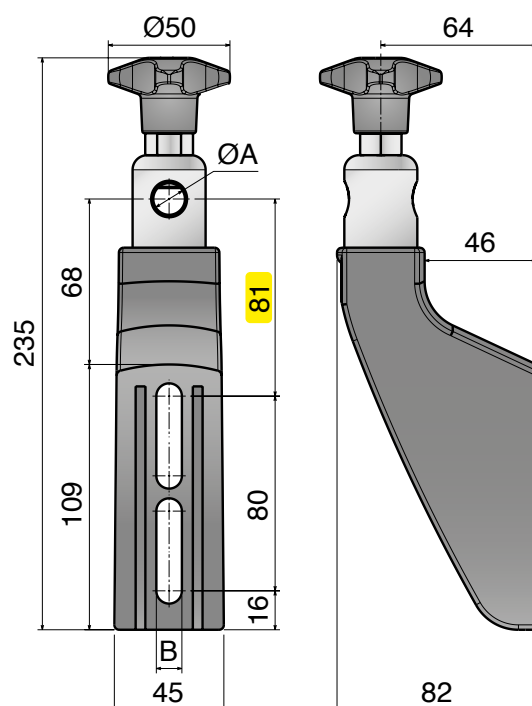

Part	Article-Nr.	ØA	B
308	30801	12	9
308	30805	14	9
308	30802	16	9
308	30803	12	10,5
308	30806	14	10,5
308	30804	16	10,5

309 Supporto laterale -grande- Side bracket -large- / Geländerhalter -groß-

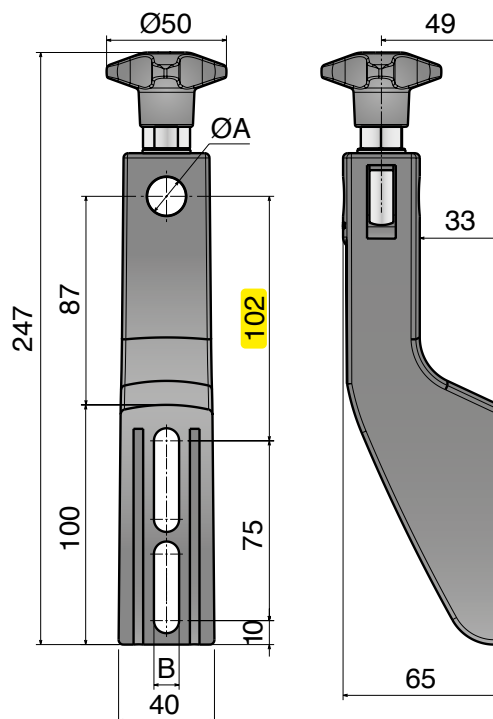

Part	Article-Nr.	ØA	B
309	30901	12	9
309	30905	14	9
309	30902	16	9
309	30903	12	10,5
309	30906	14	10,5
309	30904	16	10,5

310 Supporto laterale -grande-, volantino alto Side bracket -large-, high knob / Geländerhalter -groß-, hoher Sterngriff

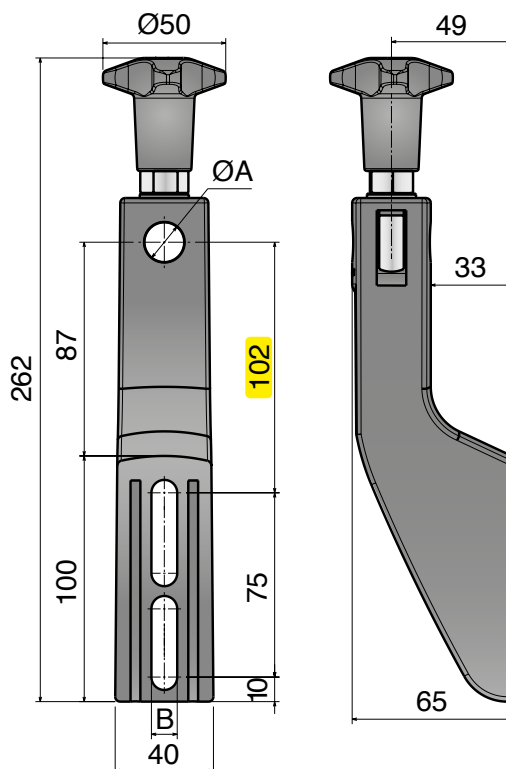

Part	Article-Nr.	ØA	B
310	31001	12	9
310	31005	14	9
310	31002	16	9
310	31003	12	10,5
310	31006	14	10,5
310	31004	16	10,5

311 Supporto laterale -grande-, orientabile Side bracket -large-, adjustable / Geländerhalter -groß-, einstellbar

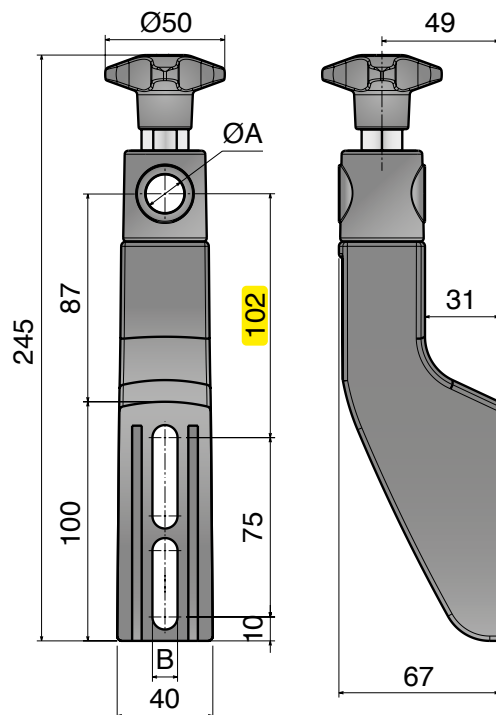

Part	Article-Nr.	ØA	B
311	31101	12	9
311	31105	14	9
311	31102	16	9
311	31103	12	10,5
311	31106	14	10,5
311	31104	16	10,5
311	31109	bracket	9
311	31110	bracket	10,5

312 Supporto laterale -grande-, orientabile INOX Side bracket -large-, adjustable SS / Geländerhalter -groß-, einstellbar Edelstahl

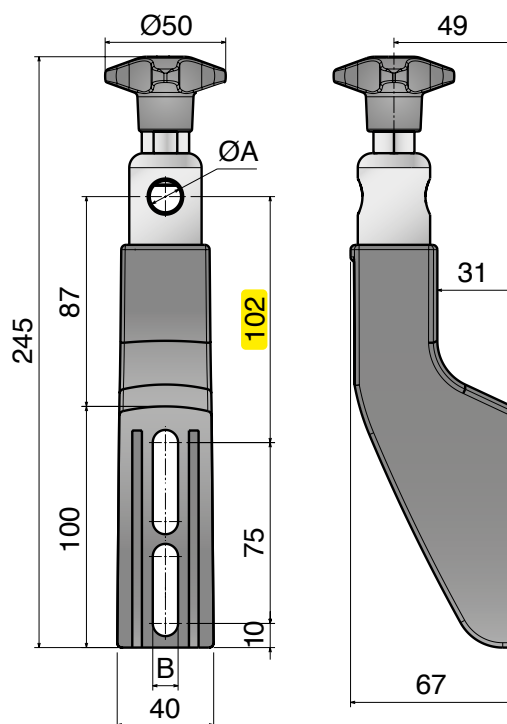

Part	Article-Nr.	ØA	B
312	31201	12	9
312	31205	14	9
312	31202	16	9
312	31203	12	10,5
312	31206	14	10,5
312	31204	16	10,5

398

Supporto laterale inox -medio- orientabile

SS bracket -medium-, adjustable / Edelstahl Geländerhalter -medium-, einstellbar

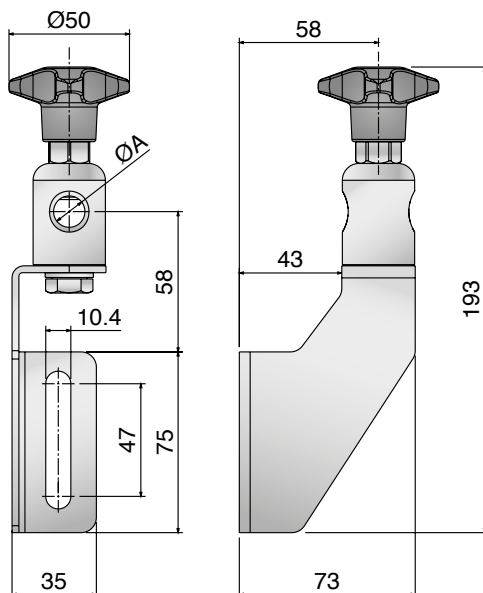

Part	Article-Nr.	$\varnothing A$
398	39860	12
398	39862	14
398	39861	16

Stainless steel
AISI 304

Supporto laterale inox -grande- orientabile

SS bracket -large-, adjustable / Edelstahl Geländerhalter -groß-, einstellbar

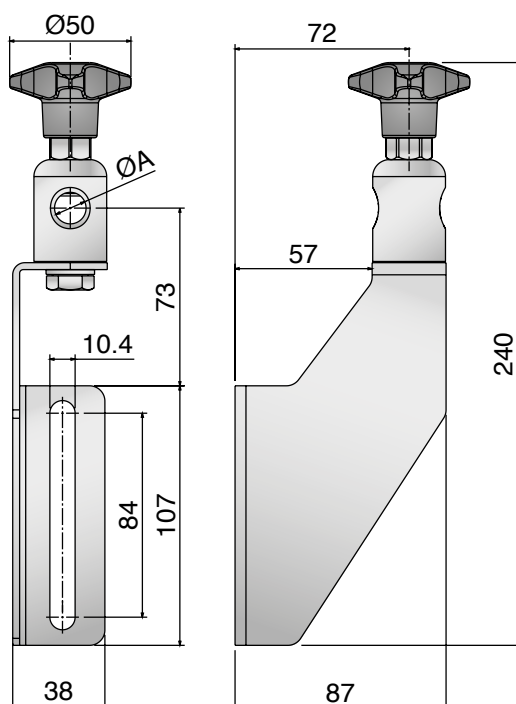

Part	Article-Nr.	$\varnothing A$
398	39870	12
398	39872	14
398	39871	16

Stainless steel
AISI 304

Materiale / Material / Materialien:

Volantino: PA+ottone nichelato Knob: PA+nickel plated brass Sterngriff: PA+ Messing vernickelt

Tirante: Acciaio inox Eyebolt: Stainless steel Augenschraube: Edelstahl

Testina: PA o Acciaio inox Heads: PA or stainless steel Schwenkopf: PA oder Edelstahl

Vite, rondella e dado: Acciaio inox Screw, washers and nut: Stainless steel Schraube, Unterlegs und Mutter: Edelstahl

313-314

Componenti / Conveyor components / Komponenten

313

Testina orientabile

Adjustable head / Schwenkopf

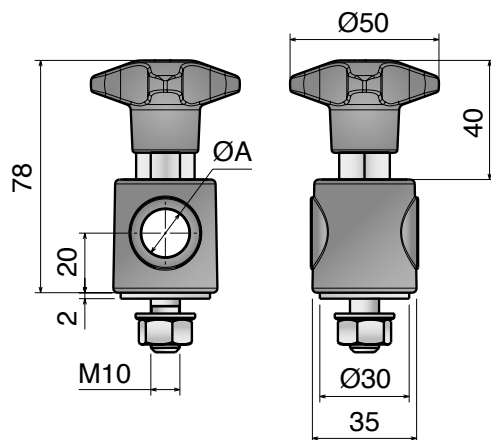

Part	Article-Nr.	ØA
313	31301	12
313	31303	14
313	31302	16
313	31311	12-without knob
313	31313	14-without knob
313	31312	16-without knob

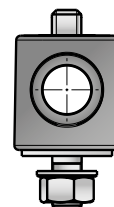

Without knob



Spacer
31330

314

Testina orientabile, acciaio inox

Adjustable head, stainless steel / Schwenkopf, Edelstahl

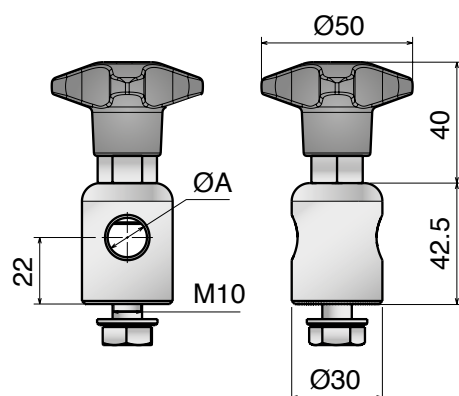

Part	Article-Nr.	ØA
314	31401	12
314	31403	14
314	31402	16
314	31411	12-without knob
314	31413	14-without knob
314	31412	16-without knob



Without knob

Testina orientabile alta, acciaio inox

Adjustable head, stainless steel / Schwenkopf, Edelstahl

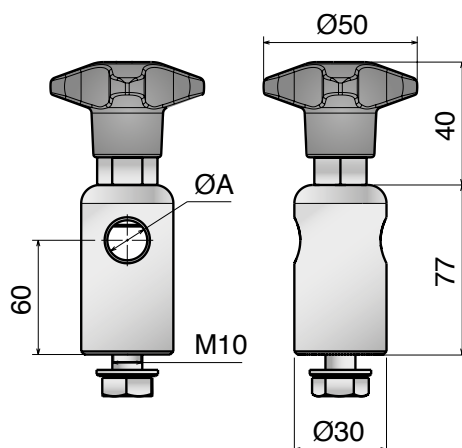

Part	Article-Nr.	ØA
314	31409	12
314	31414	14
314	31410	16
314	31419	12-without knob
314	31421	14-without knob
314	31420	16-without knob



Without knob

Movex

315 Supporto laterale "L" L-bracket / Winkel



Part	Article-Nr.	Type
315	31501	A
315	31502	B

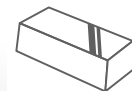

**Stainless steel
AISI 304**

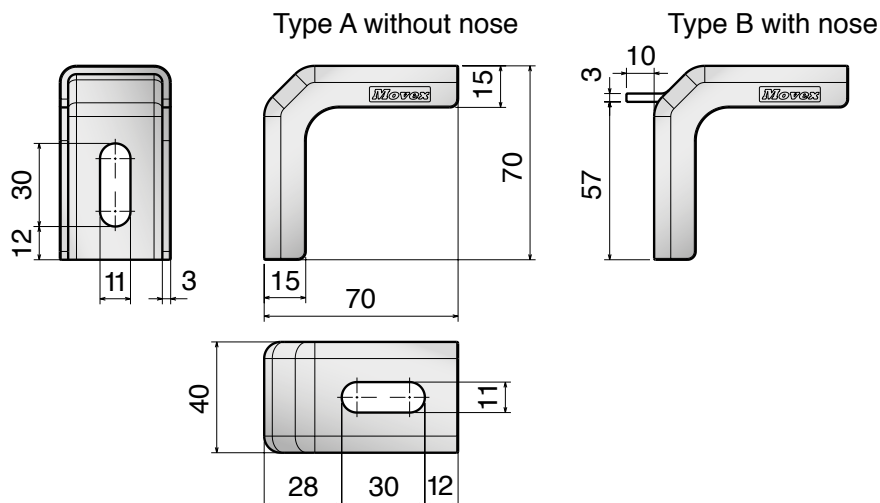

316 Supporto laterale "L" L-bracket / Winkel



Part	Article-Nr.	Type
316	31601	A
316	31602	B



**Stainless steel
AISI 304**

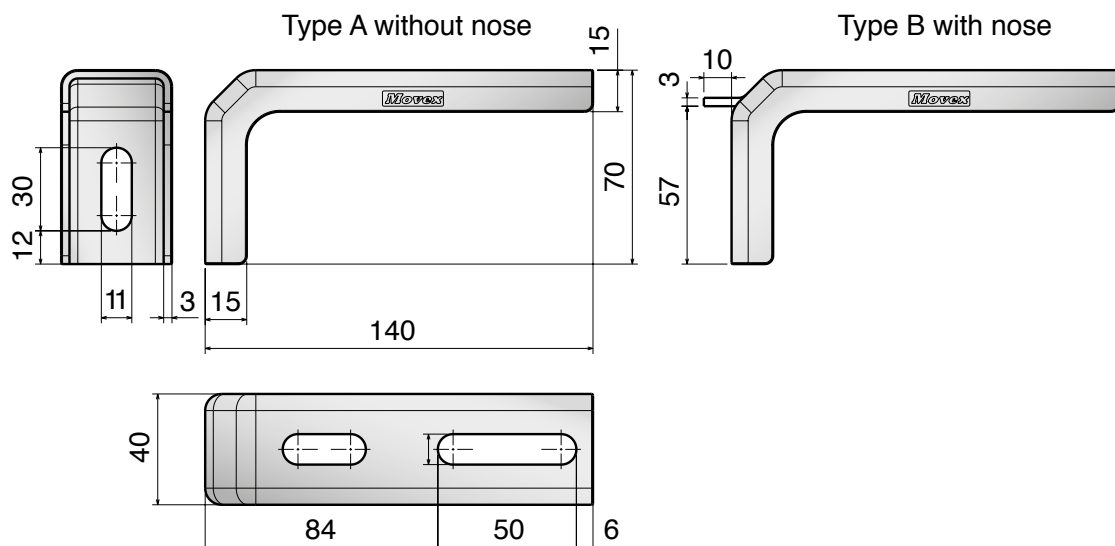

317

Volantino Star knob / Sterngriff

Part	Article-Nr.	Ø
317	31701	50
317	31702	40

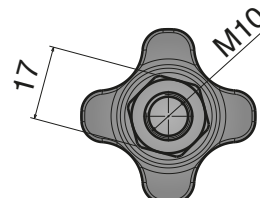
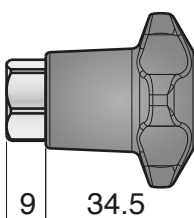
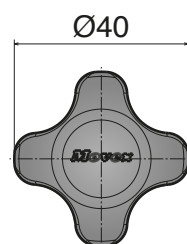
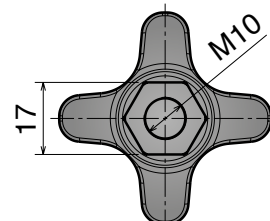
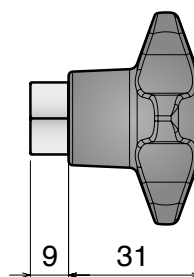
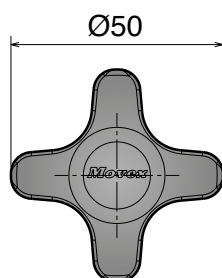

Volantino con tirante Star knob with eye-bolt / Sterngriff mit Augenschraube

Part	Article-Nr.	ØA
317	31799	12
317	31797	14
317	31798	16

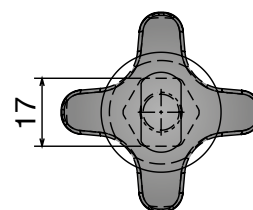
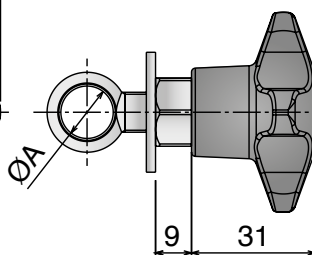
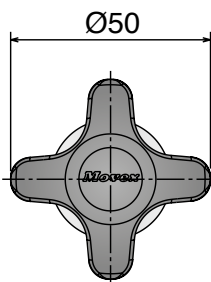

318

Volantino Star knob / Sterngriff

Part	Article-Nr.
318	31801

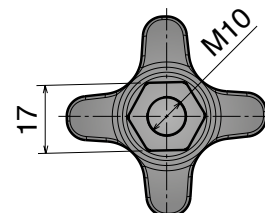
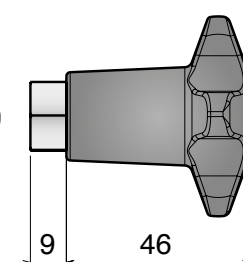
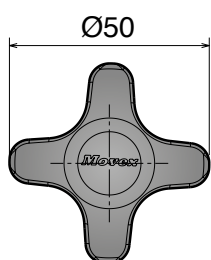

319 Volantino Star knob / Sterngriff

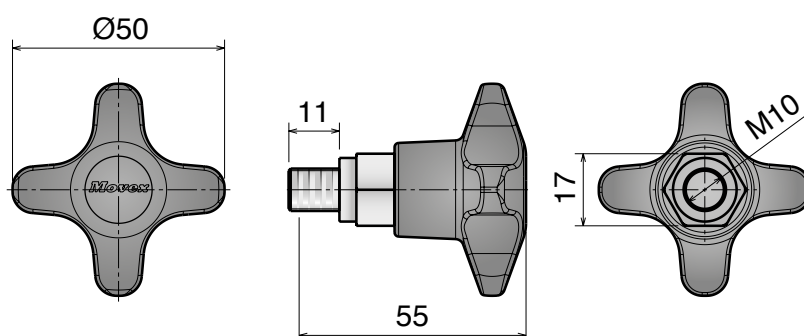

Part	Article-Nr.	Ø
319	31901	50

320 Volantino Ø80 Star knob Ø80 / Sterngriff Ø80

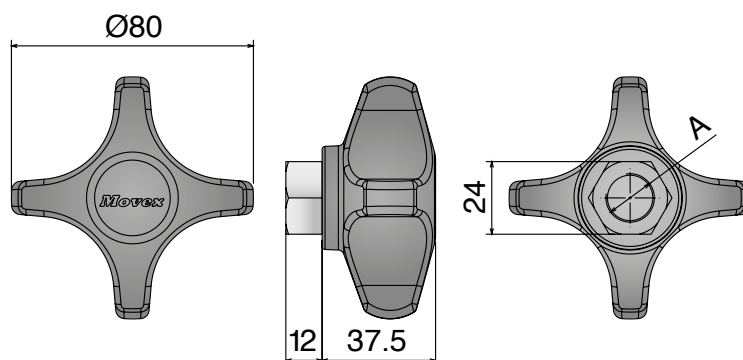

Part	Article-Nr.	A
320	32001	M12
320	32002	M16

321 Distanziale per supporto -piccolo- Spacer for bracket -small- / Distanzstück für Geländerhalter -klein-

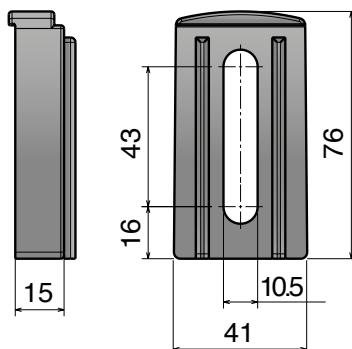

Part	Article-Nr.
321	32101

Use with bracket
part. 301-302
page 301

322 Distanziale per supporto -medio- Spacer for bracket -medium- / Distanzstück für Geländerhalter -medium-

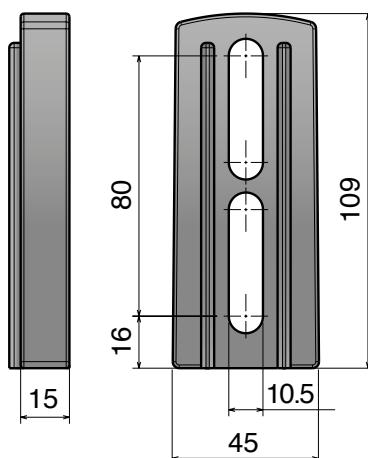

Part	Article-Nr.
322	32201

Use with bracket
part. 305-306-307-308
pages 302-303

323 Distanziale per supporto -grande- Spacer for bracket -large- / Distanzstück für Geländerhalter -groß-

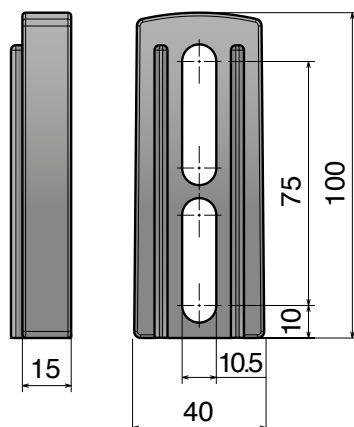

Part	Article-Nr.
323	32301

Use with bracket
part. 309-310-311-312
pages 304-305

324

Morsetto singolo per guida laterale conica

Single clamp for conical side guide / Einfachklemme für konische Seitenführung

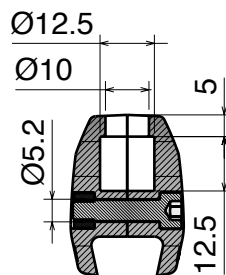
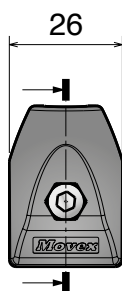

Part	Article-Nr.
324	32401

Consult pag 318
for pin design

325

Morsetto singolo per guida laterale conica

Single clamp for conical side guide / Einfachklemme für konische Seitenführung

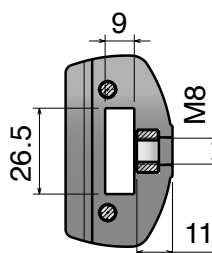
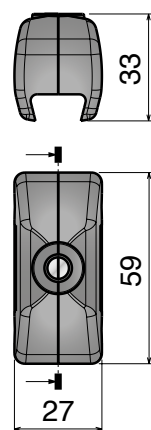

Part	Article-Nr.
325	32501

326

Morsetto singolo per guida laterale conica

Single clamp for conical side guide / Einfachklemme für konische Seitenführung

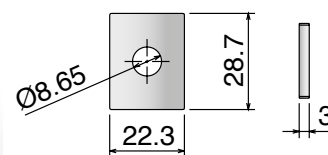
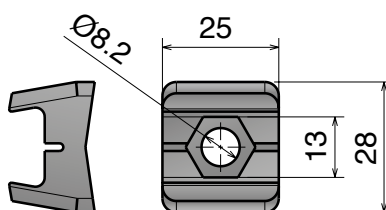

Reinforcement plate Art-Nr. 33201

Part	Article-Nr.
326	32601

327

Morsetto doppio per guida laterale conica

Double clamp for conical side guide / Doppelklemme für konische Seitenführung

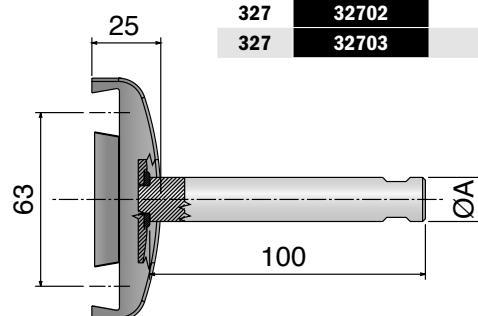
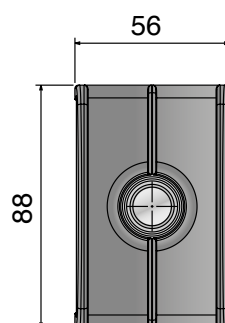

Part	Article-Nr.	ØA
327	32701	without pin
327	32702	12
327	32703	16

328

Morsetto singolo per guida laterale conica

Single clamp for conical side guide / Einfachklemme für konische Seitenführung

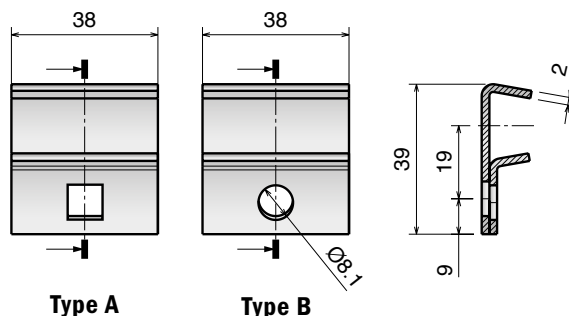

Part	Article-Nr.	Material	Type
328	32801	AISI 304	A
328	32802	AISI 304	B
328	32811	AISI 316	A

329

Morsetto doppio per guida laterale conica

Double clamp for conical side guide / Doppelklemme für konische Seitenführung

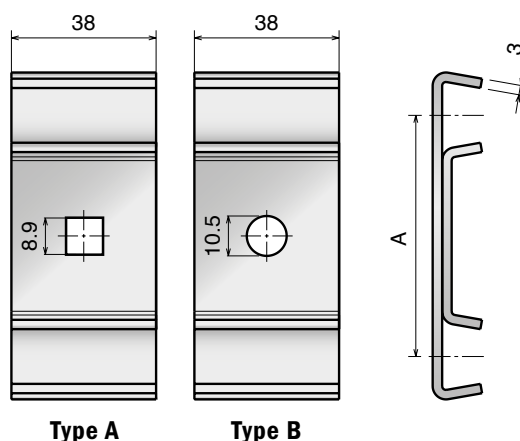

Part	Article-Nr.	A	Type
329	32904	50,0	A
329	32901	63,5	A
329	32902	82,55	A
329	32903	95,25	A
329	32911	63,5	B
329	32912	82,55	B
329	32913	95,25	B

330

Morsetto singolo per guida laterale conica

Single clamp for conical side guide / Einfachklemme für konische Seitenführung

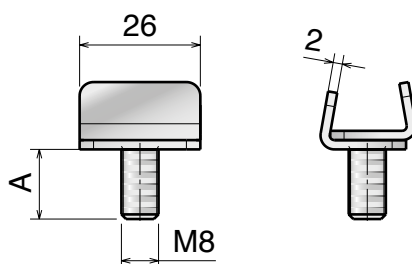

Part	Article-Nr.	A
330	33001	15
330	33002	26
330	33003	20
330	33004	30

390

Elemento di giunzione

Connecting element / Verbinder

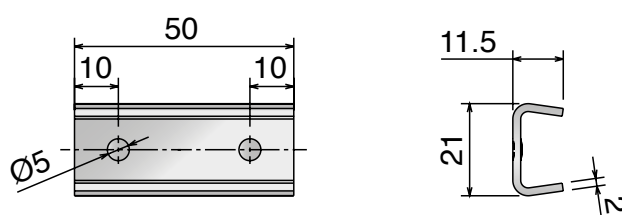

Part	Article-Nr.
390	39001

392 Elemento di connessione Connecting clamp / Verbindungsklemme

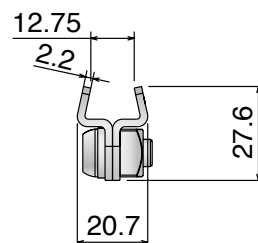
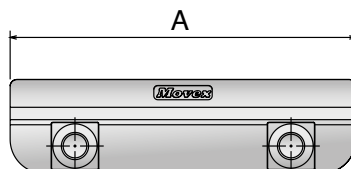

Part	Article-Nr.	A
392	39201	75
392	39202	100
392	39203	150

393 Elemento di connessione Connecting clamp / Verbindungsklemme

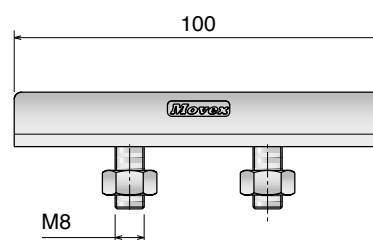
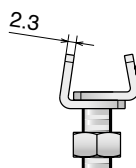

Part	Article-Nr.	A
393	39301	100

336 Morsetto aggiustabile guide coniche Adjustable clamp for conical guide / verstellbare Klemme für konische Führungen

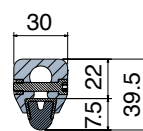
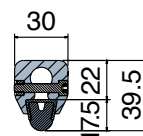
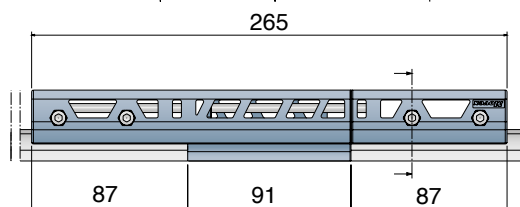
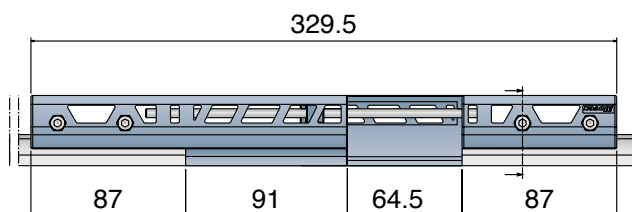
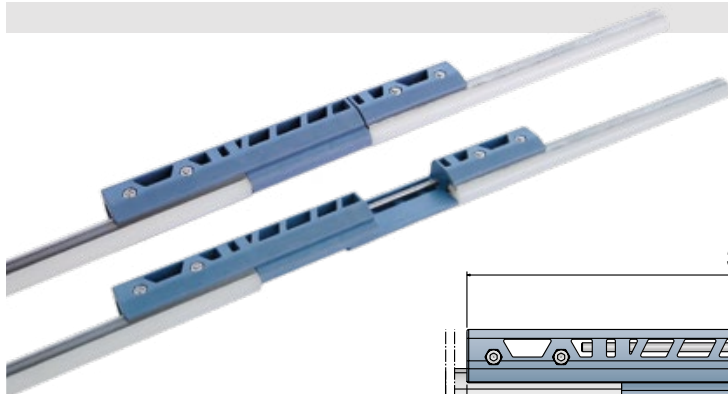

Part	Article-Nr.	
336	33601	

394 Morsetto di giunzione Joint clamp / Verbindungsplatte

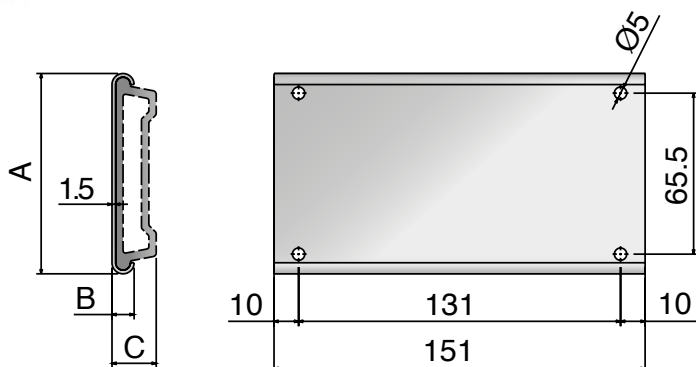
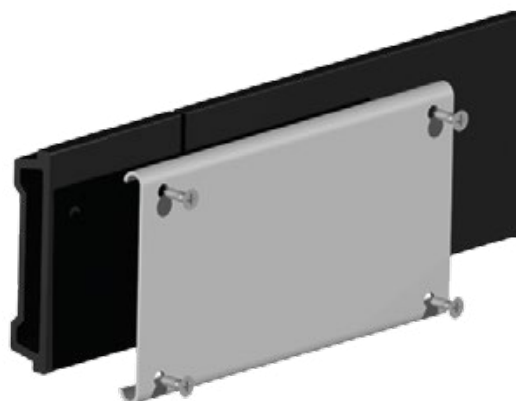

Part	Article-Nr.	ØA	B	C	Specific
394	39401	81,5	9	18	used with part 135
394	39402	90	8	17	used with part 136



Used with
Part 135
page 274



Used with
Part 136
page 274

341 Morsetto Clamp / Klemme



Type A

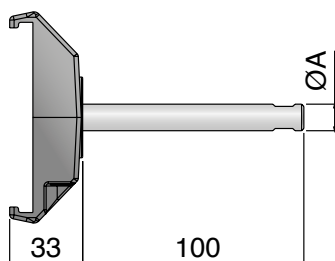

Part	Article-Nr.	ØA	Type
341	34101	without pin	A
341	34102	12	A
341	34103	16	A



Used with
Part 136
page 274



Type B

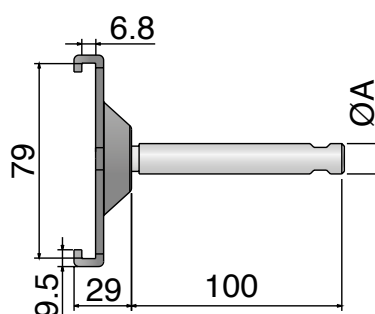

Part	Article-Nr.	ØA	Type
341	34111	without pin	B
341	34112	12	B
341	34113	16	B



Used with
Part 135
page 274

331 Morsetto acciaio inox Clamp, stainless steel / Klemme, Edelstahl



Used with
Part 135
page 274



Used with
Part 189 page 280
Part 187 page 281
Part 1056 page 282
Part 1057 page 282

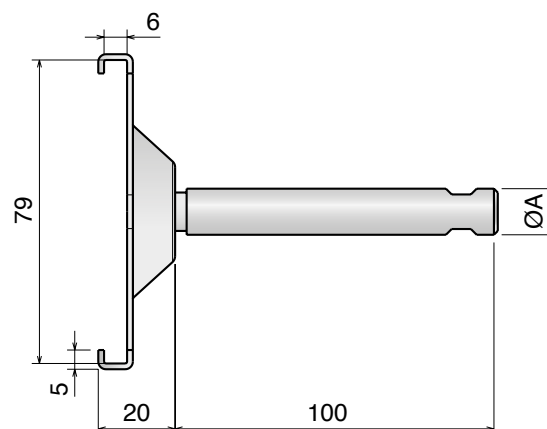

345 Morsetto acciaio inox Clamp, stainless steel / Klemme, Edelstahl



Used with
Part 136
page 274

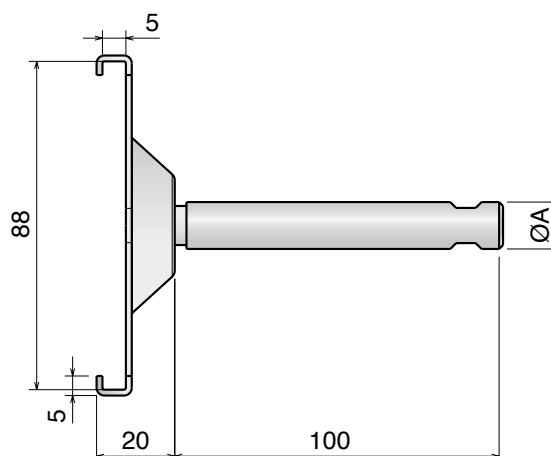

337 Morsetto singolo per tondino Single clamp for round bar / Einfachklemme für Rund Profil

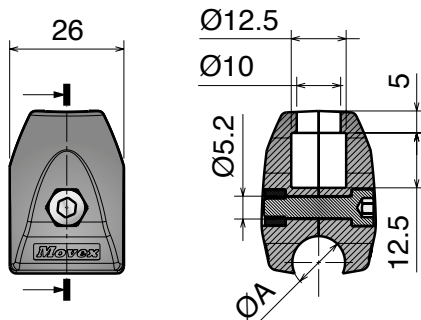

Part	Article-Nr.	ØA
337	33701	10
337	33702	12

Consult pag 318
for pin design

338 Morsetto singolo per tondino Single clamp for round bar / Einfachklemme für Rund Profil

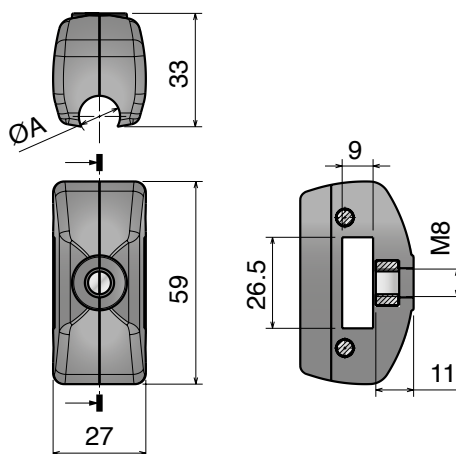

Part	Article-Nr.	ØA
338	33801	10
338	33802	12

339 Morsetto doppio per tondino Double clamp for round bar / Doppelklemme für Rund Profil

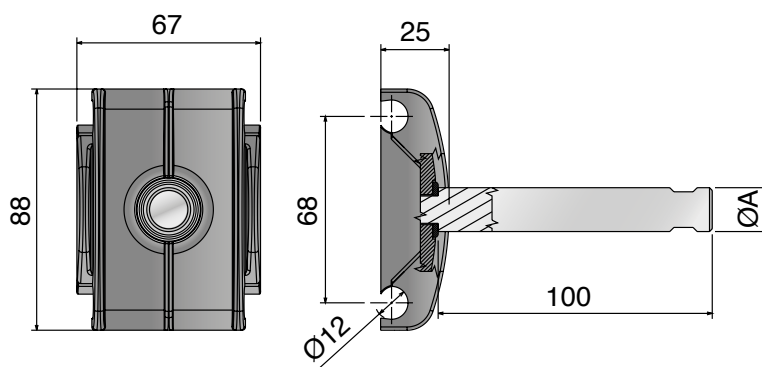

Part	Article-Nr.	ØA
339	33901	without pin
339	33902	12
339	33903	16

349 Perno Rod / Bolzen

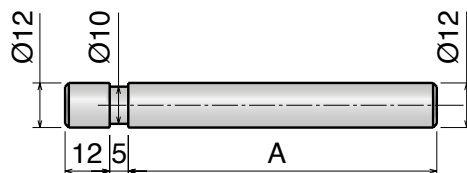

Part	Article-Nr.	A
349	34901	80
349	34902	100
349	34903	150

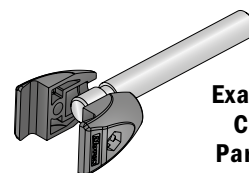

Example:
CLAMP
Part 324

350 Perno Rod / Bolzen

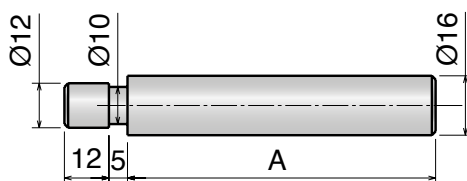

Part	Article-Nr.	A
350	35001	80
350	35002	100
350	35003	150

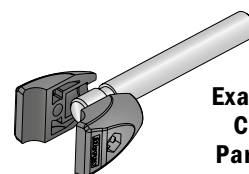

Example:
CLAMP
Part 337

351 Perno Rod / Bolzen

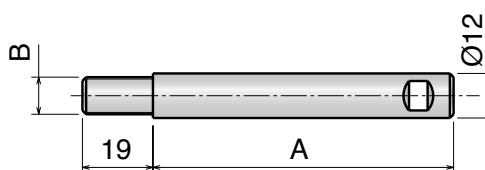

Part	Article-Nr.	A	B
351	35101	80	M10
351	35102	100	M10
351	35103	150	M10
351	35151	80	M8
351	35152	100	M8
351	35153	150	M8

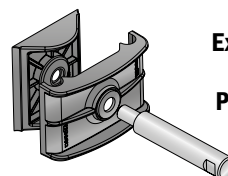

Example:
CLAMP
Part 339

352 Perno Rod / Bolzen



Part	Article-Nr.	A	B
352	35201	80	M10
352	35202	100	M10
352	35203	150	M10
352	35251	80	M8
352	35252	100	M8
352	35253	150	M8

347 Perno filettato femmina Rod / Bolzen



Part	Article-Nr.	A	B
347	34701	80	M10
347	34702	100	M10
347	34703	150	M10
347	34751	80	M8
347	34752	100	M8
347	34753	150	M8

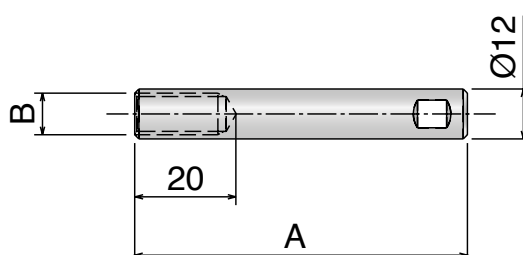

348 Perno filettato femmina Rod / Bolzen



Part	Article-Nr.	A	B
348	34801	80	M10
348	34802	100	M10
348	34803	150	M10
348	34851	80	M8
348	34852	100	M8
348	34853	150	M8

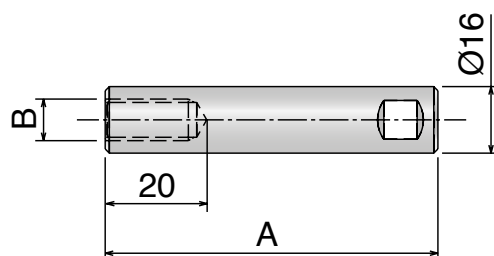

346 Snodo Joint rod adapter / Gelenk



Part	Article-Nr.	A	B	C
346	34601	M8	M8	19
346	34602	M8	M10	19
346	34603	M10	M10	19
346	34699	M8	M8	16

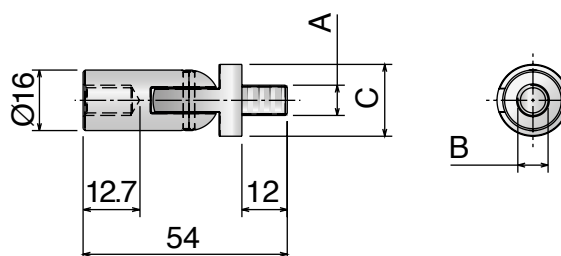

356 Perno snodato Jointed rods / Gelenkbolzen



Part	Article-Nr.	A
356	35601	80
356	35602	100
356	35603	150

Use with bracket
Part 324-337

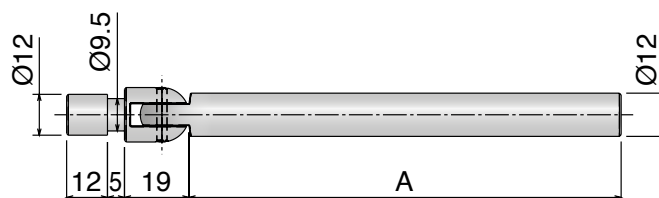

357 Perno snodato Jointed rods / Gelenkbolzen



Part	Article-Nr.	A
357	35701	80
357	35702	100
357	35703	150

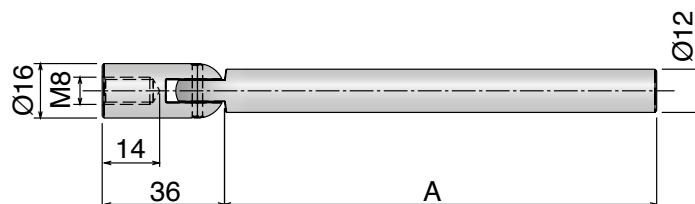

335

Guide a rulli laterale Roller guides / Röllchenführung

New Patented

Max fixing load M8 screw: 15 N/m

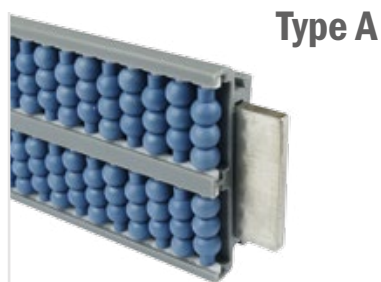

Type A

Part	Article-Nr.	Type
335	33502	A



Type B

Part	Article-Nr.	Type
335	33504	B



Type B1

Part	Article-Nr.	Type
335	33506	B1

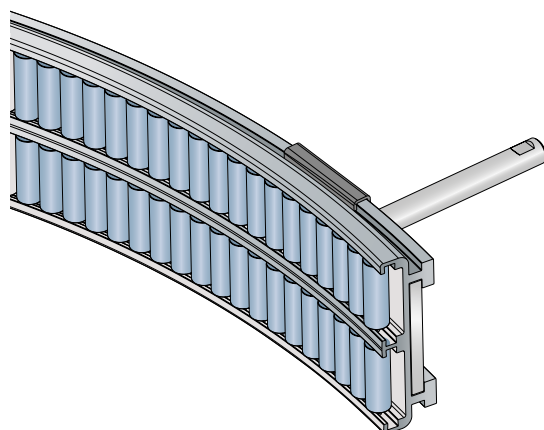
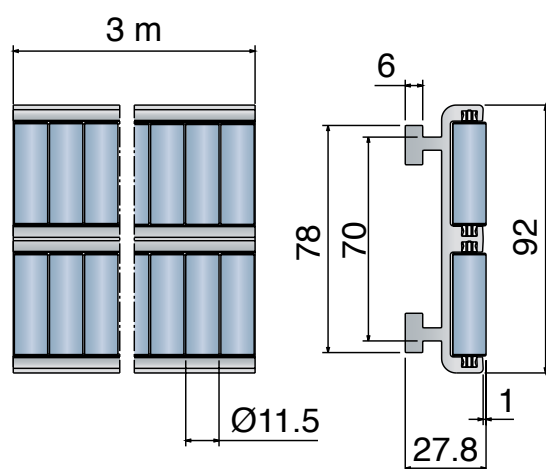
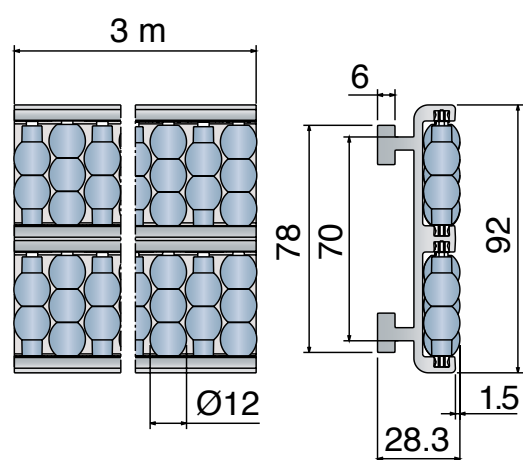

**Available roller
 for bending
 machine**

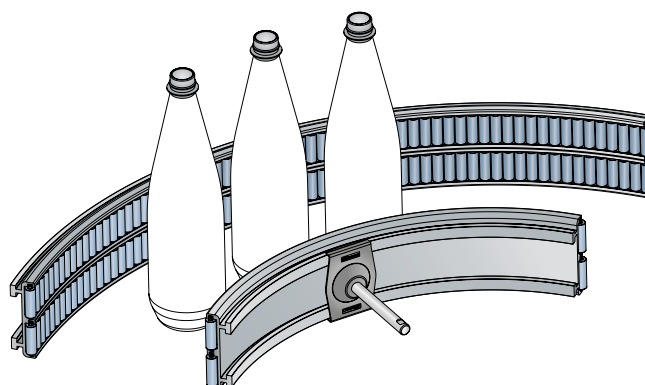
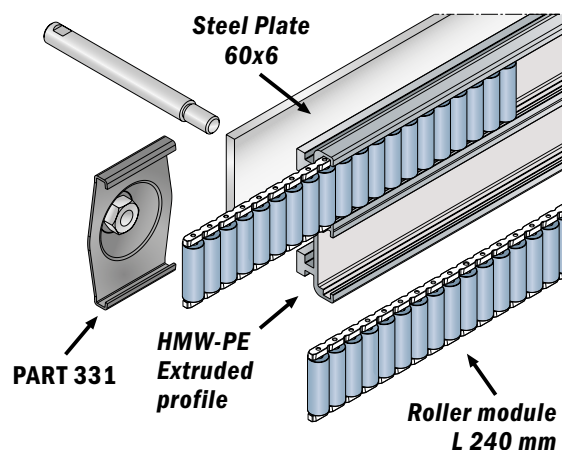

Materiale / Material / Materialien:

Guida: alluminio anodizzato/Guide: anodized aluminum/Führung: eloxiertem Aluminium

Rulli: resina acetica o gomma SEBS/Rollers: Acetal Resin or SEBS rubber/Röllchen: Azetal oder SEBS gummi

Vite: Acciaio inox Screw: Stainless steel Schrauben: Edelstahl

358

Guide a rulli laterale
Roller guides / Röllchenführung

Max fixing load M8 screw: 15 N/m

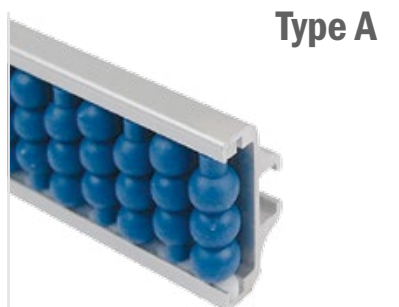
**Type A**

Part	Article-Nr.	Type
358	35802	A

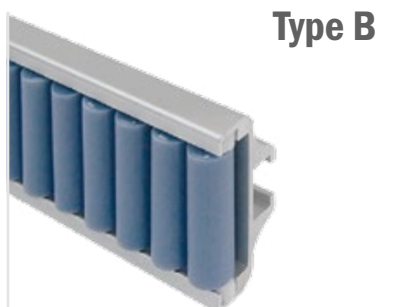
**Type B**

Part	Article-Nr.	Type
358	35804	B

**Type B1**

Part	Article-Nr.	Type
358	35806	B1

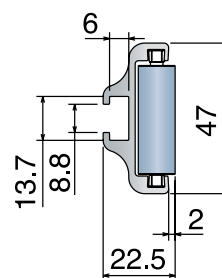
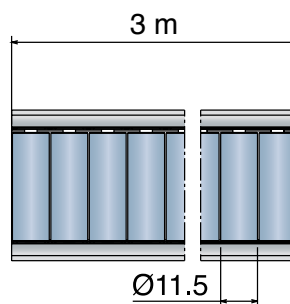
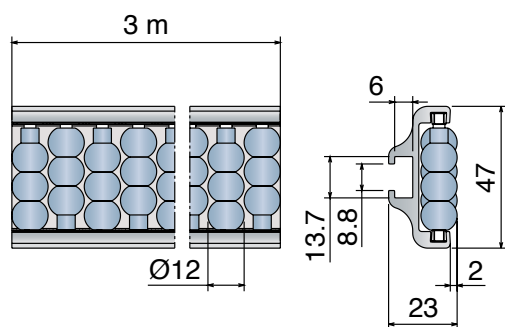
**Soft roller**
SEBS rubberFixing screw:
M8 hex.head
or **PART 362****Puntale / Shoe / Einlaufschuh**

Part	Article-Nr.	Type
364	36401	fresato/machined/gefräst

Materiale / Material / Materialien:

Guida: alluminio anodizzato/Guide: anodized aluminum/Führung: eloxiertem Aluminium

Rulli: resina acetica o gomma SEBS/Rollers: Acetal Resin or SEBS rubber/Röllchen: Azetal oder SEBS gummi

Vite: Acciaio inox Screw: Stainless steel Schrauben: Edelstahl

359

Componenti / Conveyor components / Komponenten

359

Guide a rulli laterale

Roller guides / Röllchenführung

Max fixing load M8 screw: 15 N/m



Type A

Part	Article-Nr.	Type
359	35902	A



Type B

Part	Article-Nr.	Type
359	35904	B



Type B1

Part	Article-Nr.	Type
359	35906	B1

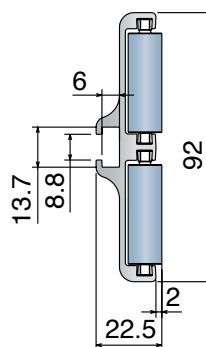
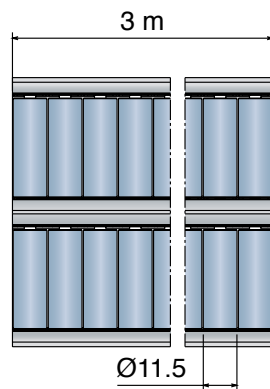
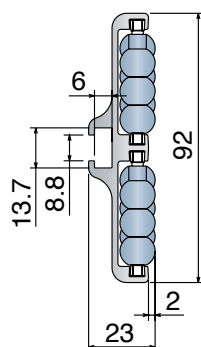
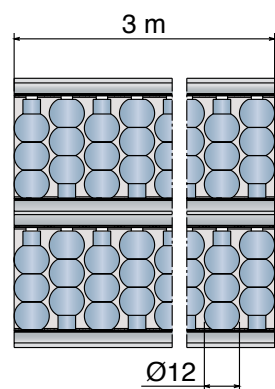

Soft roller
SEBS rubber

Fixing screw:
M8 hex.head
or PART 362



Puntale / Shoe / Einlaufschuh



Part	Article-Nr.	Type
365	36501	fresato/machined/gefräst

Materiale / Material / Materialien:

Guida: alluminio anodizzato/Guide: anodized aluminum/Führung: eloxiertem Aluminium
Rulli: resina acetica o gomma SEBS/Rollers: Acetal Resin or SEBS rubber/Röllchen: Azetal oder SEBS gummi

360

Guide a rulli intermedia
Roller guides / Röllchenführung

Max fixing load M8 screw: 15 N/m

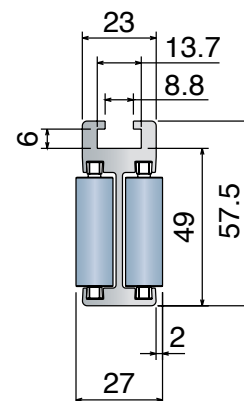
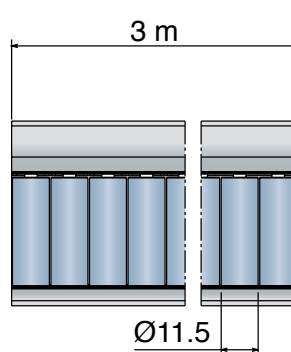
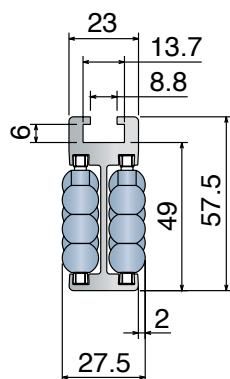
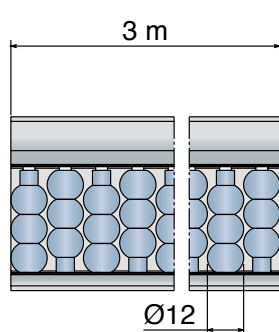
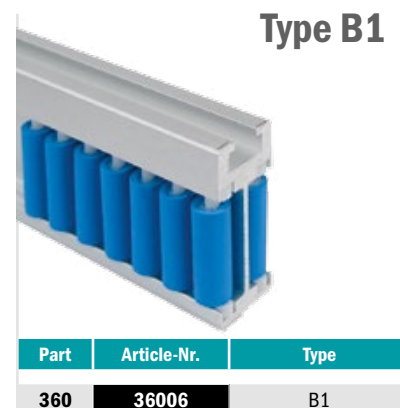
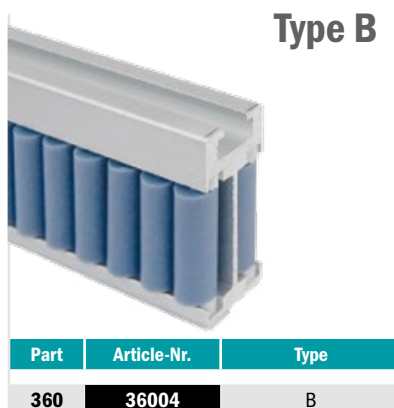
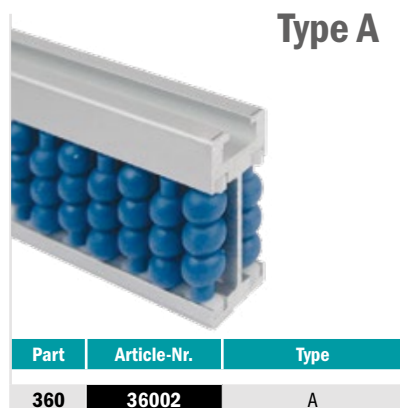

Fixing screw:
M8 hex.head
or **PART 362**



Puntale / Shoe / Einlaufschuh



Part	Article-Nr.	Type
366	36601	fresato/machined/gefräst

361

Guide a rulli intermedia Roller guides / Röllchenführung

Max fixing load M8 screw: 15 N/m

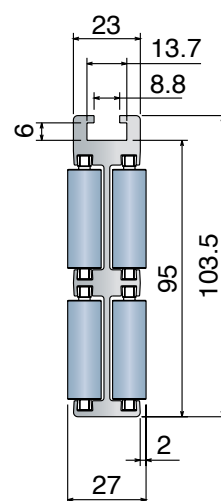
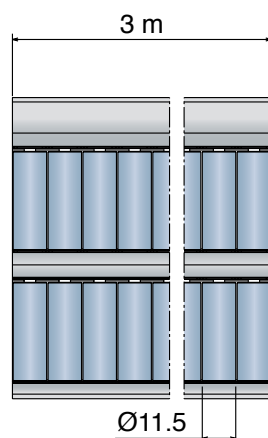
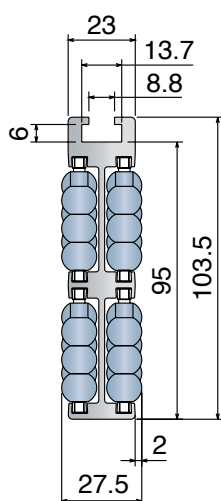
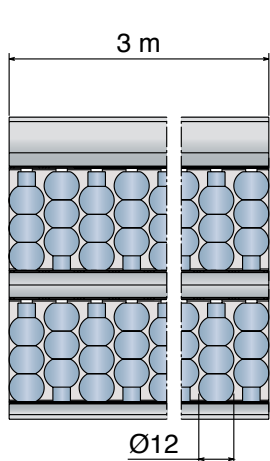
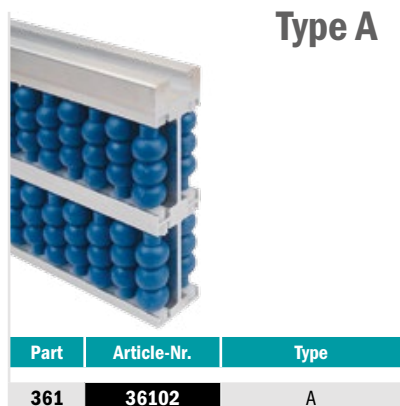

Fixing screw:
M8 hex.head
or **PART 362**



Puntale / Shoe / Einlaufschuh



Part	Article-Nr.	Type
367	36701	fresato/machined/gefräst

366 Puntale centrale a rulli Central roller shoe / Einlaufschuh mitting

Patented



Type B1
Soft roller
SEBS rubber

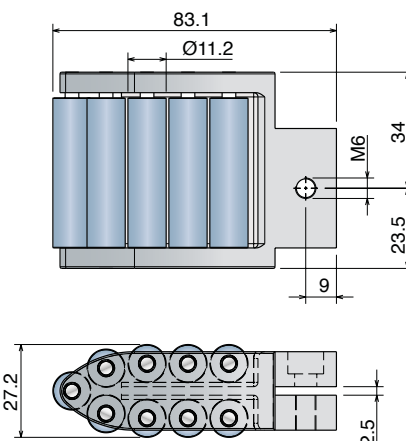
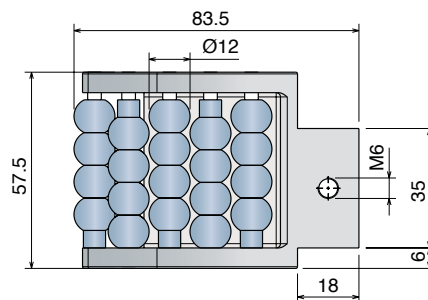

Part	Article-Nr.	Type
366	36621	A
366	36622	B
366	36623	B1

367 Puntale centrale a rulli Central roller shoe / Einlaufschuh mitting

Patented



Type B1
Soft roller
SEBS rubber

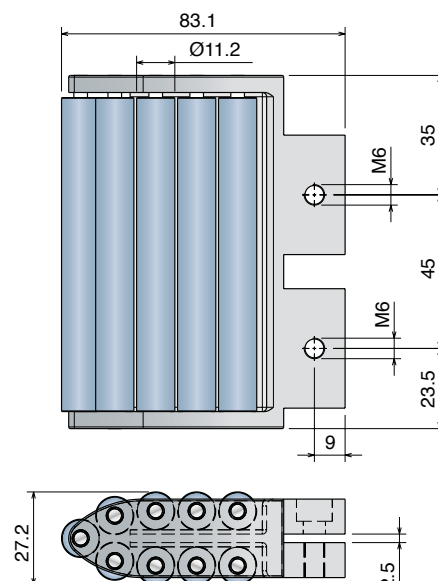
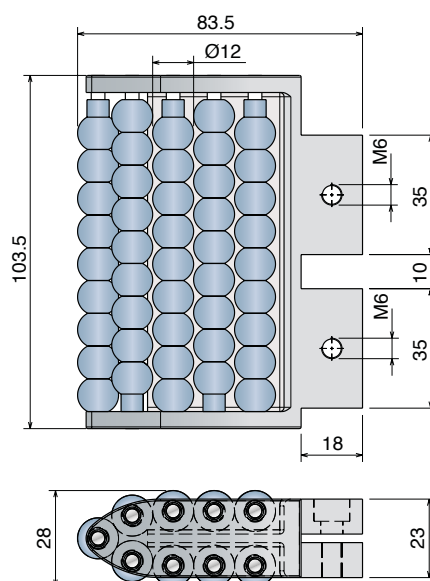

Part	Article-Nr.	Type
367	36721	A
367	36722	B
367	36723	B1

364 Puntale laterale a rulli Side roller shoe / Einlaufschuh seitlich

Patented



Type B1
Soft roller
SEBS rubber

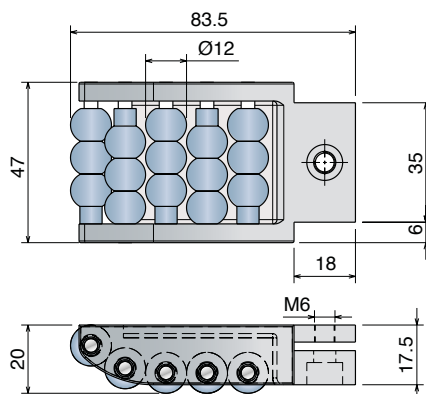

Part	Article-Nr.	Type
364	36421	A
364	36422	B
364	36423	B1

365 Puntale laterale a rulli Side roller shoe / Einlaufschuh seitlich

Patented



Type B1
Soft roller
SEBS rubber

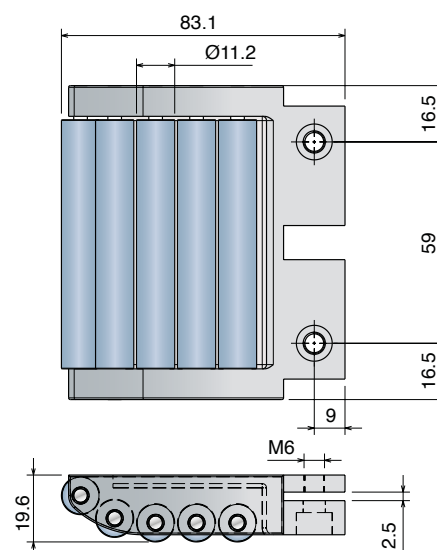
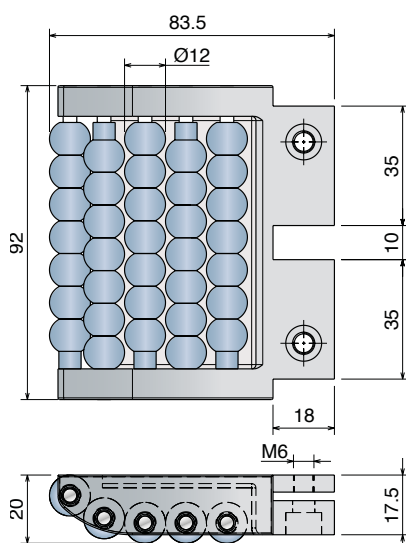

Part	Article-Nr.	Type
365	36521	A
365	36522	B
365	36523	B1

395 Guida laterale in PE PE side guides / Seitenführung in PE

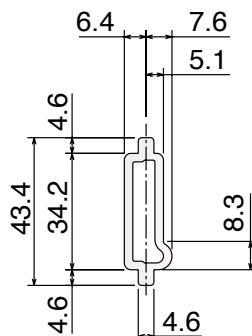
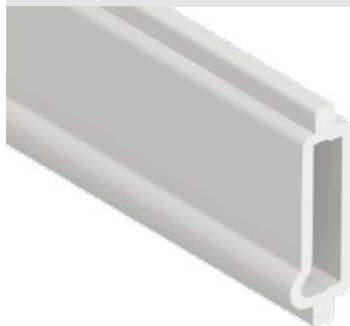

Part	Article-Nr.	A
395	39501	80

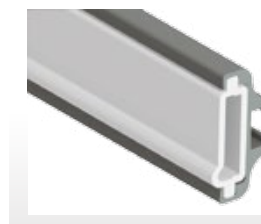

362 Vite a "T" T-bolt / T-Schraube

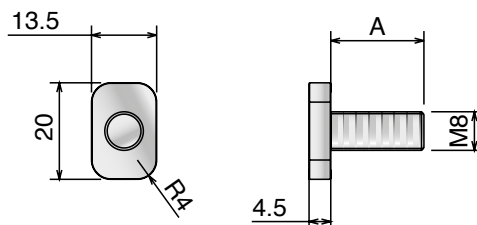

Part	Article-Nr.	A
362	36201	16
362	36202	19
362	36203	25

358 Guide in alluminio Aluminum guides / Aluminiumführung

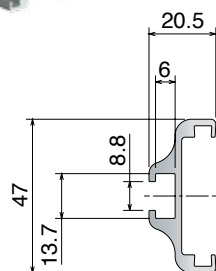
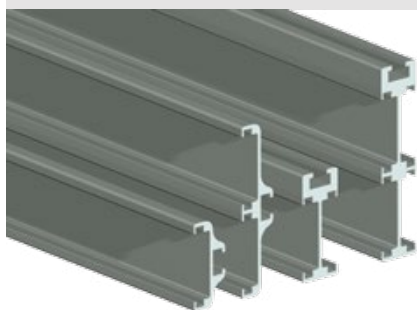

35800

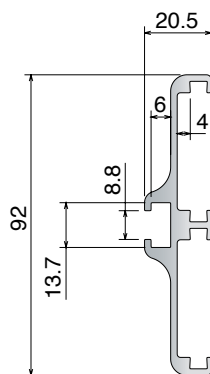

35900

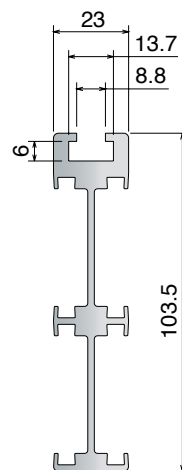

36100

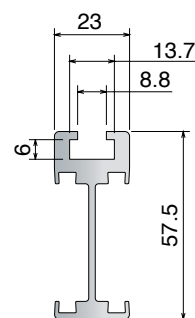

36000

Part	Article-Nr.	Version	Min. radius
358	35800	Single-lateral	250
359	35900	Double-lateral	500
360	36000	Single-central	500
361	36100	Double-central	750

333 Elemento di giunzione Connecting elements / Verbindungselement

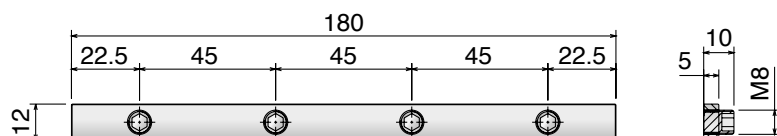
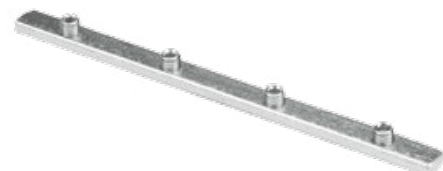

Part	Article-Nr.
333	33301

353 Guide a rulli di accumulo Accumulation roller guides / Stauröllchenführung



Part	Article-Nr.	A	Pin	Pin DIA
353	35301	1 m	PA	6
353	35302	2 m	PA	6
353	35303	3 m	PA	6

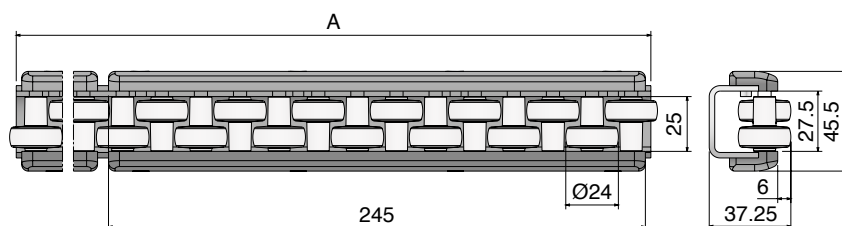

354 Guide a rulli di accumulo Accumulation roller guides / Stauröllchenführung



Part	Article-Nr.	A	Pin	Pin DIA
354	35401	1 m	PA	6
354	35402	2 m	PA	6
354	35403	3 m	PA	6

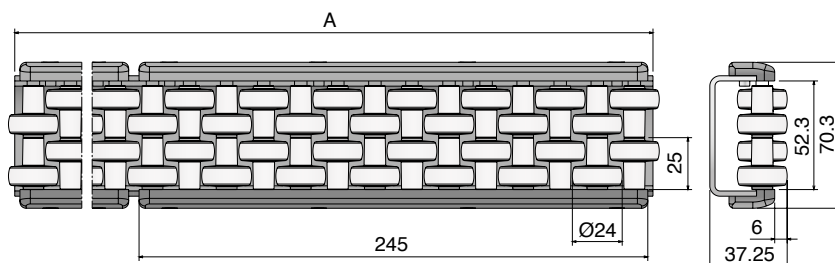

355 Guide a rulli di accumulo Accumulation roller guides / Stauröllchenführung



Part	Article-Nr.	A	Pin	Pin DIA
355	35501	1 m	PA	6
355	35502	2 m	PA	6
355	35503	3 m	PA	6

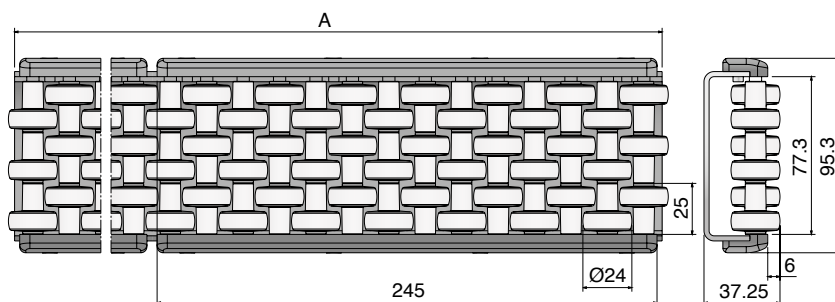

363

Guida a rulli flessibile
Flexible roller guide / Flexible Röllchenführung

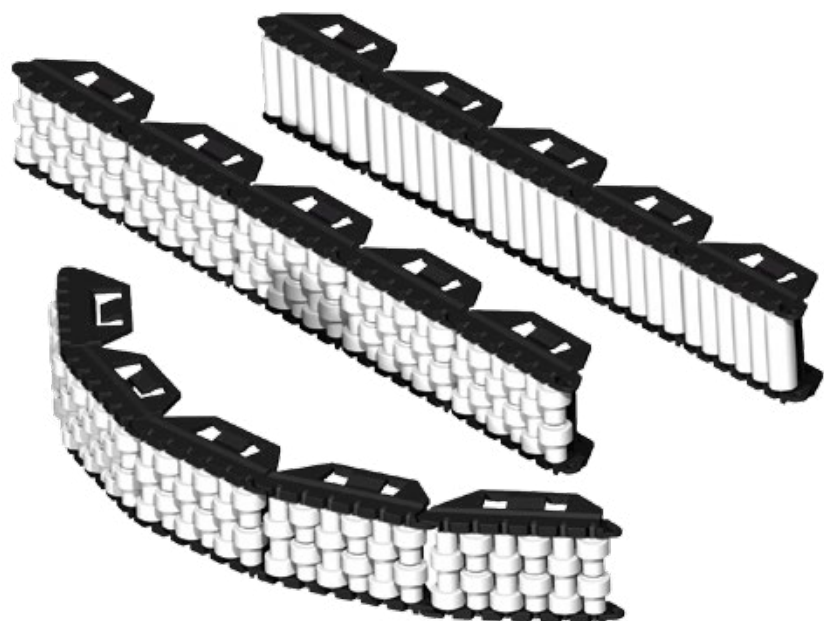

Part	Article-Nr.	Type	A
363	36301	A	8
363	36302	B	8
363	36303	A	10
363	36304	B	10

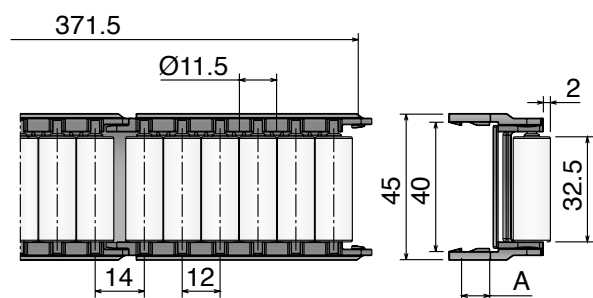

Type A

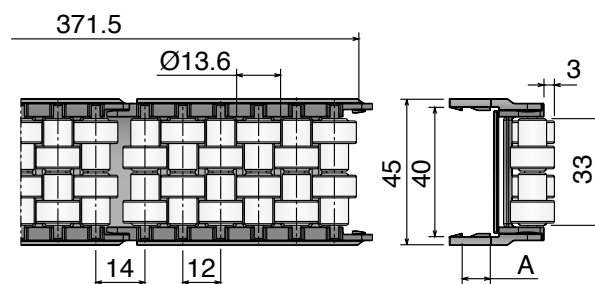

Type B

Curvature radius

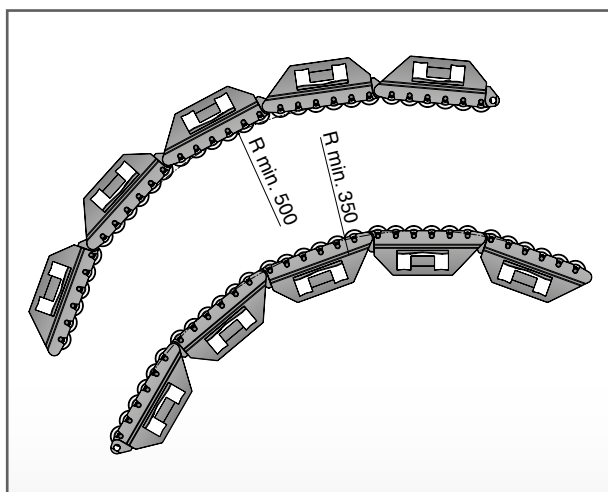

Fixing with plate and metal profile

Fixing with plate:

- 40x8
- 40x10

Fixing with Metal:

Part. 117
Part. 1055

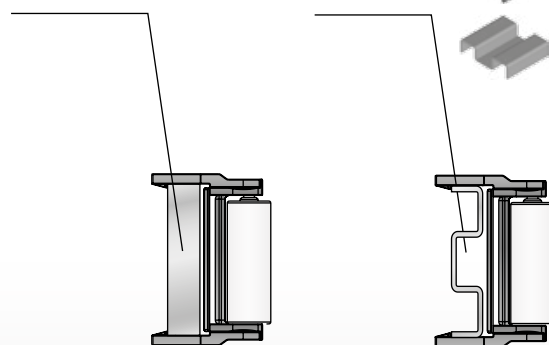

396

Guida a rulli flessibile
Flexible roller guide / Flexible Röllchenführung

Part	Article-Nr.	Type
396	39601	A
396	39602	B

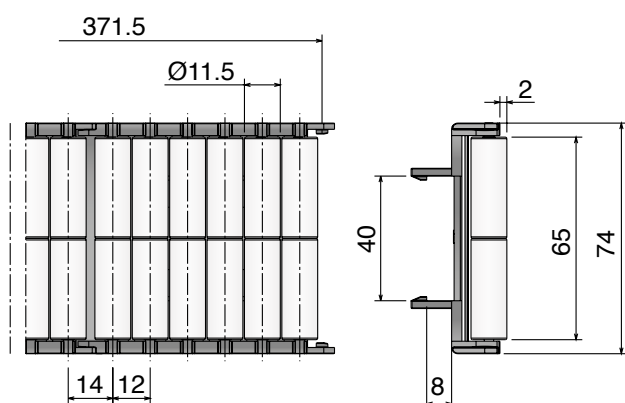
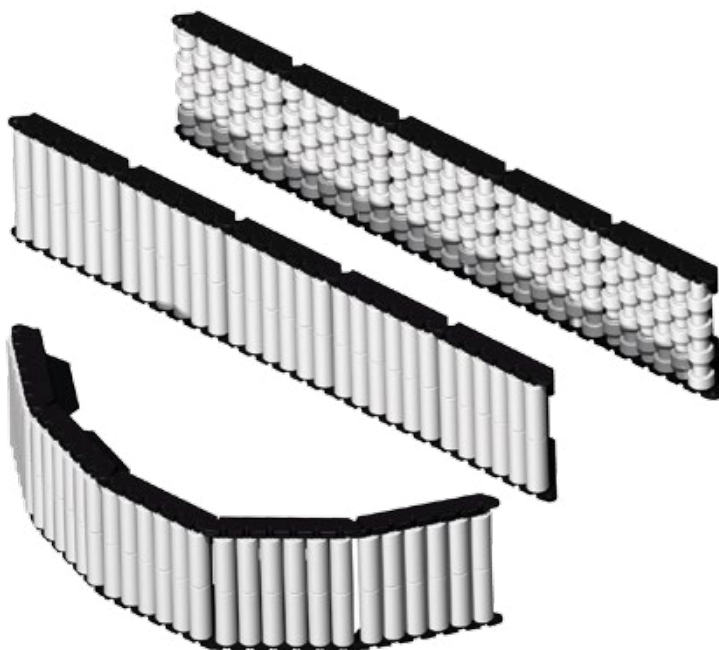

Type A

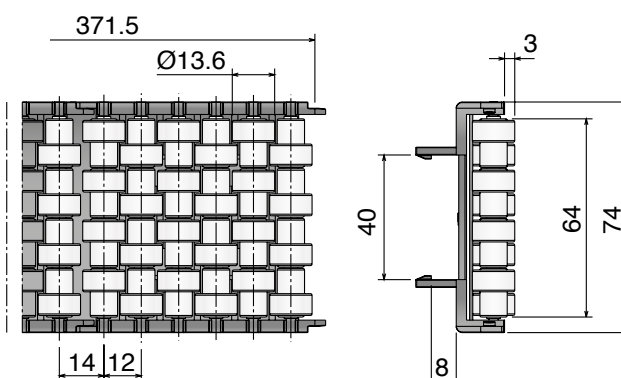

Type B

Curvature radius

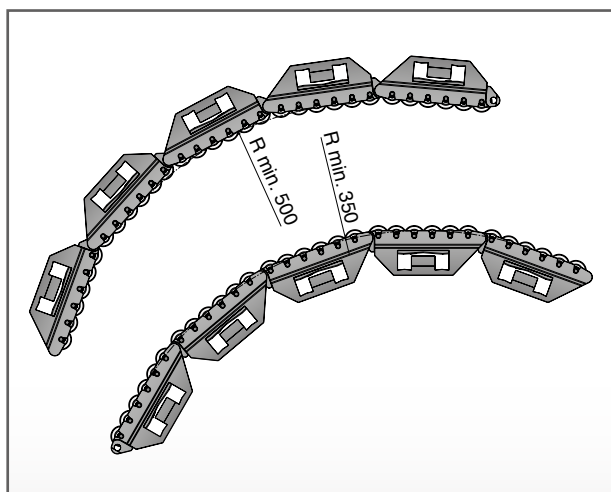

Fixing with plate and metal profile

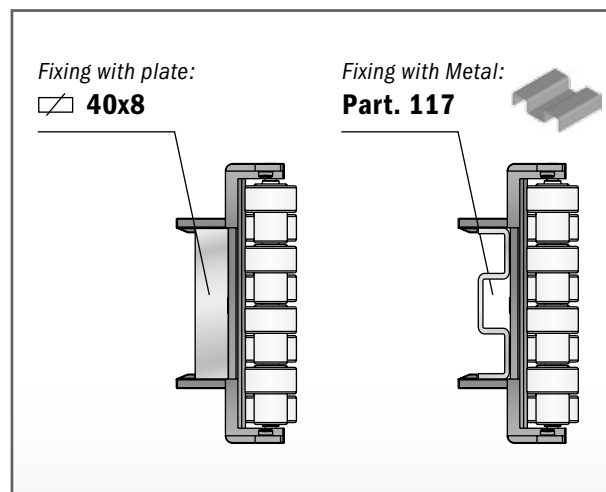

363

Guida a rulli flessibile (centrale)
Flexible roller guide (Centre) / Flexible Röllchenführung (Zentral)

Part	Article-Nr.	Type	for plate
363	36311	A	40x10
363	36312	B	40x10



Type A

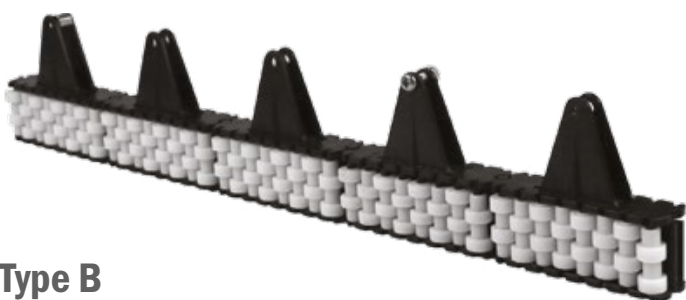
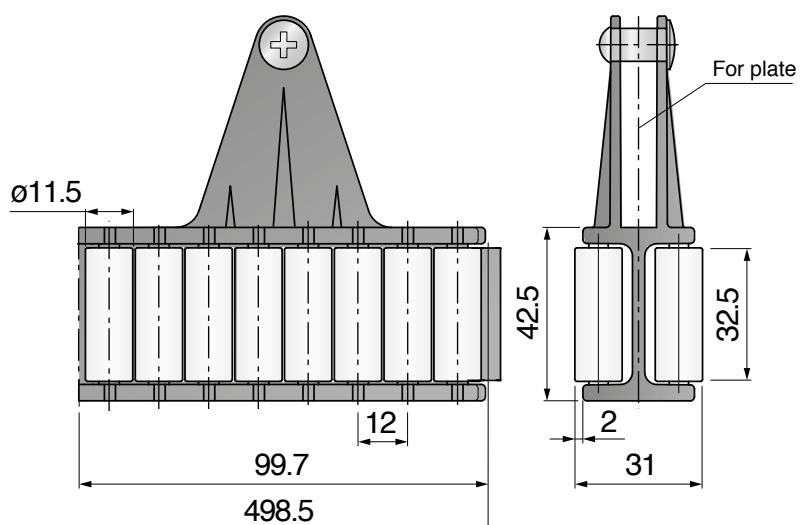

Type B

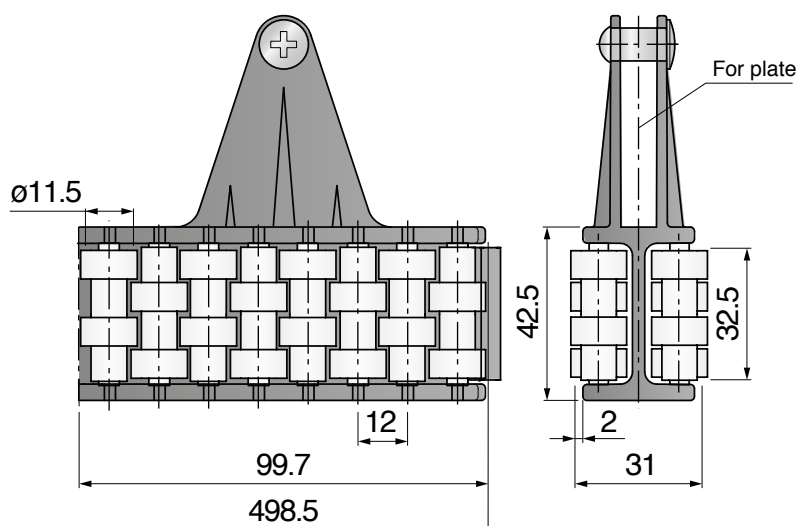

199

Blocco di montaggio catena

Chain mounting block / Kettenmontageblock

Part	Article-Nr.	A	B	C
199	19980	45	80	40
199	19981	60	100	55
199	19982	45	80	40

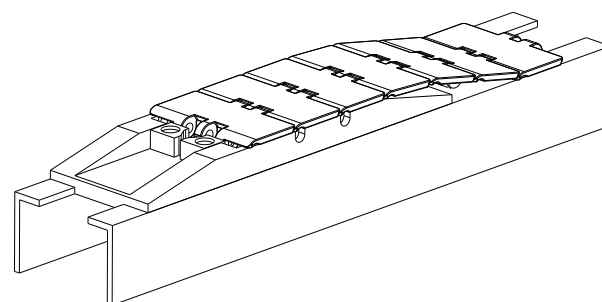
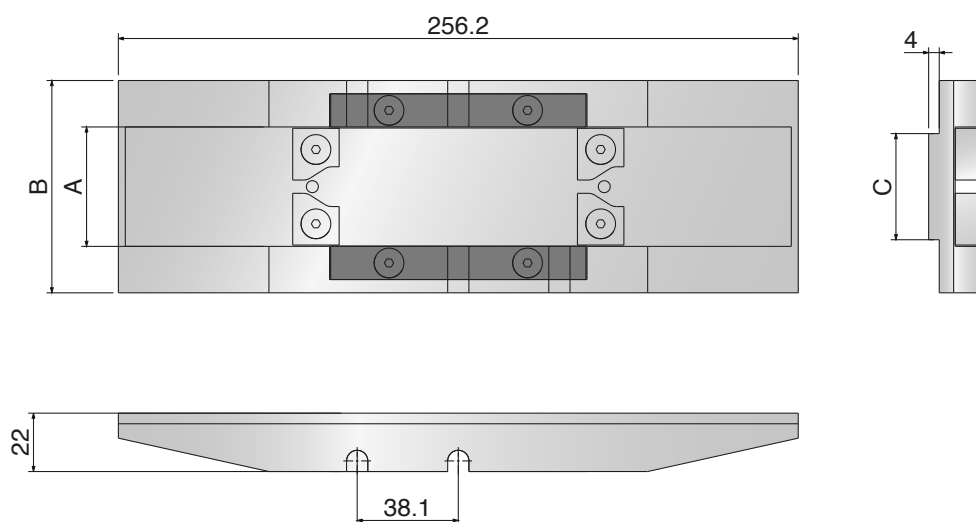

Chain mounting block application

368 Moduli di trasferimento L=85 mm Transfer modules L=85 mm / Überschubmodul L=85 mm

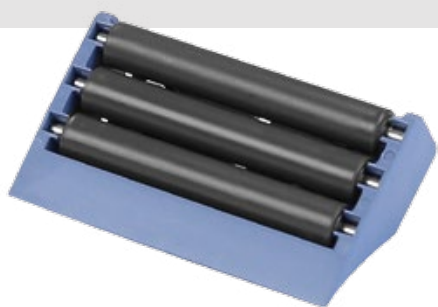

Part	Article-Nr.	Type	Roller material
368	36801	A	Acetal resin
368	36802	B	Acetal resin
368	36803	C	Acetal resin
368	36801SS	A	Stainless steel
368	36802SS	B	Stainless steel
368	36803SS	C	Stainless steel



Smart Roll
with mini
bearing
in stainless
steel

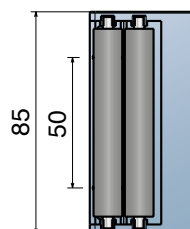
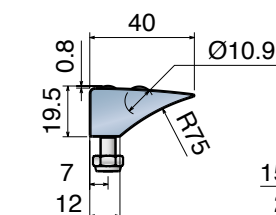

Type A

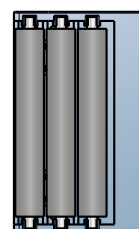
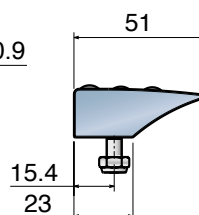

Type B

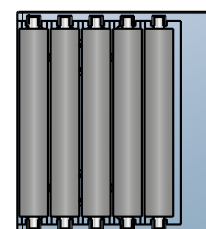
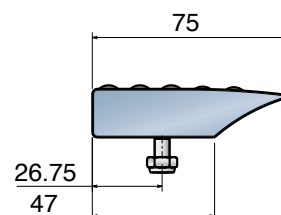

Type C

369 Moduli di trasferimento L=115 mm Transfer modules L=115 mm / Überschubmodul L=115 mm

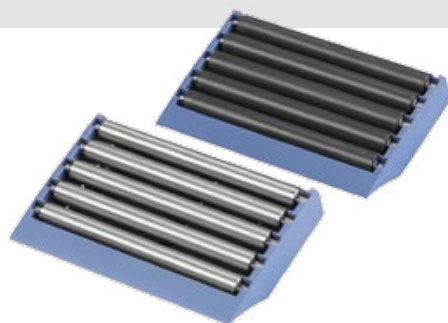

Part	Article-Nr.	Type	Roller material
369	36901	A	Acetal resin
369	36902	B	Acetal resin
369	36903	C	Acetal resin
369	36901SS	A	Stainless steel
369	36902SS	B	Stainless steel
369	36903SS	C	Stainless steel



Smart Roll
with mini
bearing
in stainless
steel

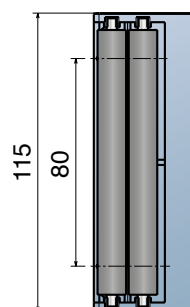
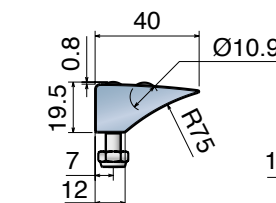

Type A

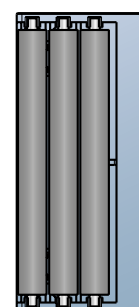
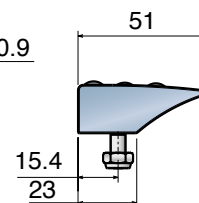

Type B

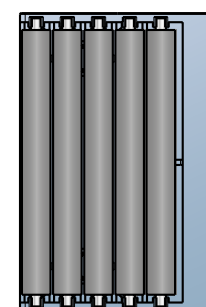
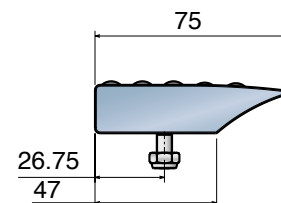

Type C

370 Moduli di trasferimento L=85 mm Transfer modules L=85 mm / Überschubmodul L=85 mm

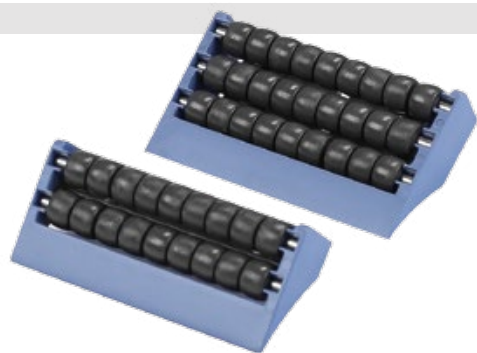

Part	Article-Nr.	Type
370	37001	A
370	37002	B
370	37003	C

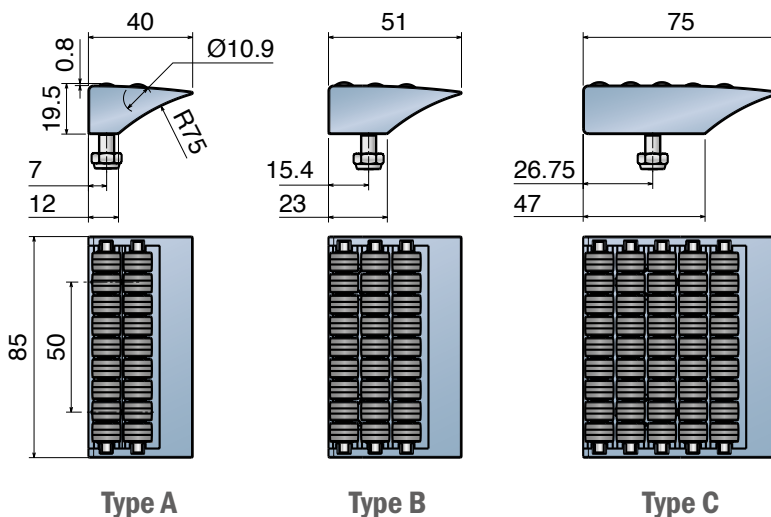

371 Moduli di trasferimento L=115 mm Transfer modules L=115 mm / Überschubmodul L=115 mm

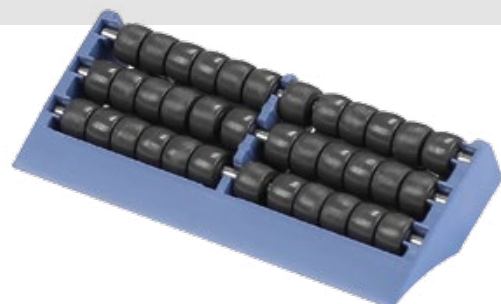

Part	Article-Nr.	Type
371	37101	A
371	37102	B
371	37103	C

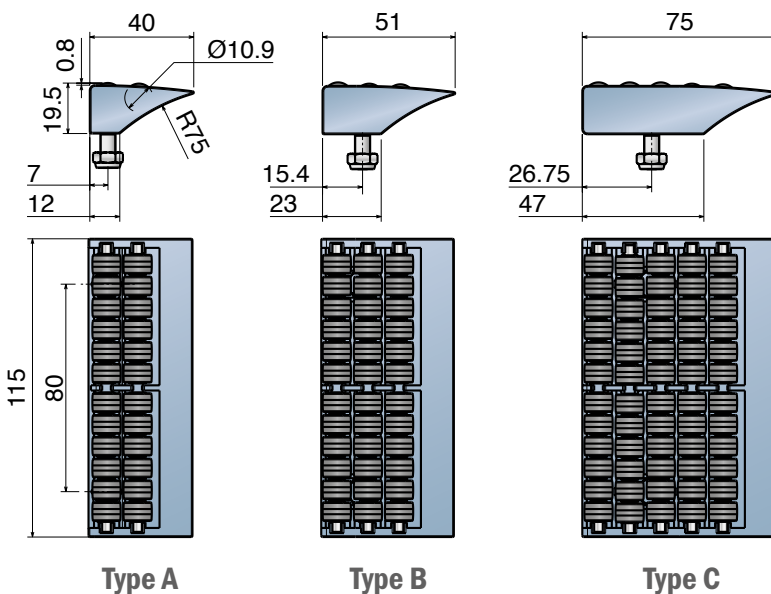

372

Cerniera

Hinge / Scharnier

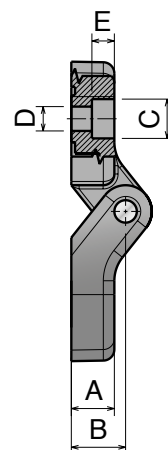
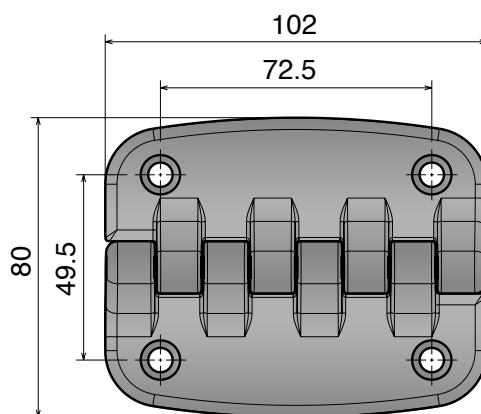

Part	Article-Nr.	A	B	C	D	E
372	37201	11	14	10,5	6,5	6
372	37202	11	14	13,5	8,5	8
372	37203	18	21	13,5	8,5	8

373

Cerniera

Hinge / Scharnier

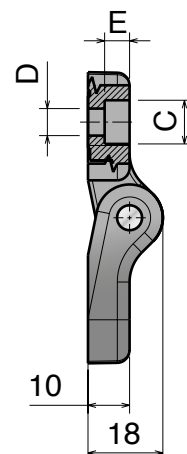
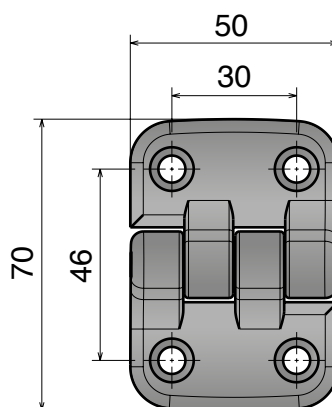

Part	Article-Nr.	C	D	E
373	37301	10,5	6,5	6
373	37302	13,5	8,5	4

383 Cerniera Hinge / Scharnier



Part	Article-Nr.	A	B	C	ØD	ØE	F	G
383	38301	24	25	14,5	4,5	14	44,6	41
383	38302	36	36	20,8	6,5	20	62,5	58

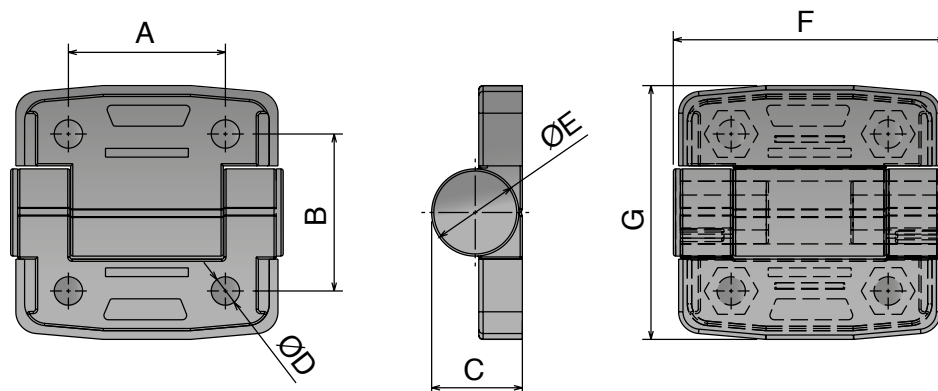

384 Cerniera Acciaio Inox SS Hinge / Edelstahl Scharnier



Part	Article-Nr.	A	B	C	ØD	ØE	F	G
384	38401	20	32,5	4,3	5,5	10,5	40	51
384	38402	30	41	5	6,5	12,5	60	71

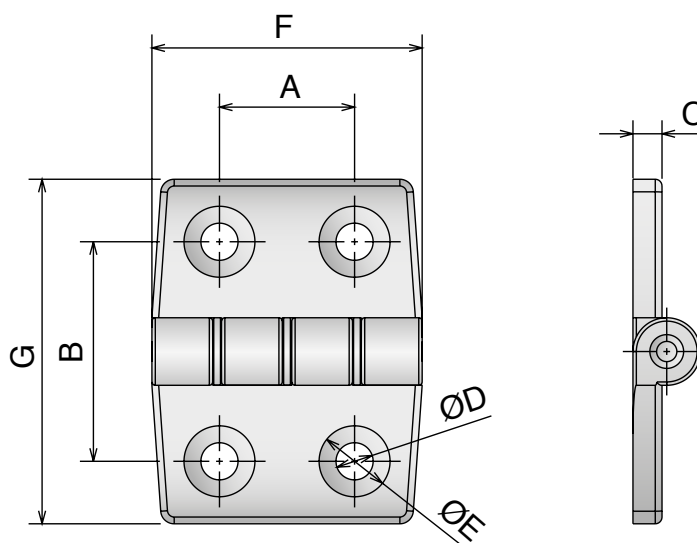

385 Maniglia ad impugnatura morbida Soft touch handle / Handgriffe "Soft Touch"



Part	Article-Nr.
385	38501

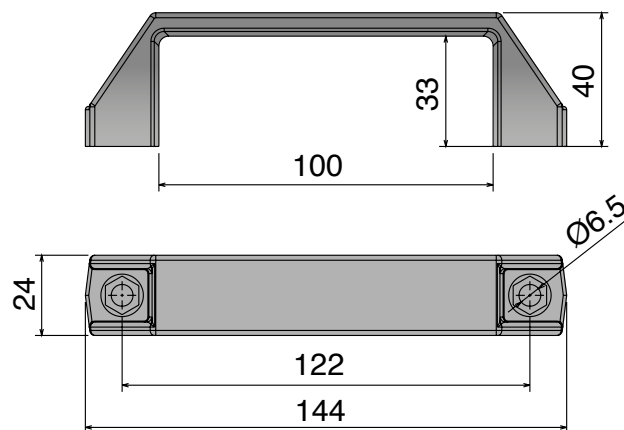

386 Maniglia Handle / Handgriff



Part	Article-Nr.	A	B	C	Ød	ØD	E	F
386	38601	120	140	40	8,8	13	24,5	16
386	38602	160	185	48	8,8	15	29	16

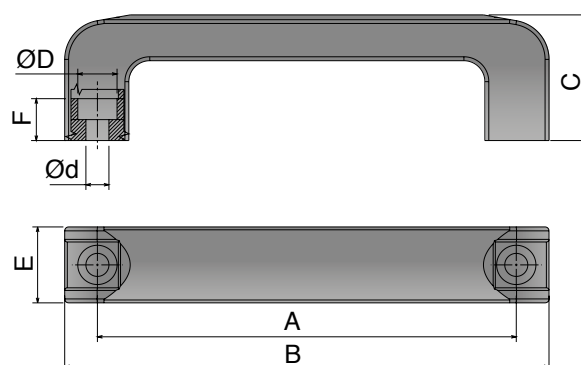

397 Maniglia acciaio inox Stainless Steel handle / Handgriffe Edelstahl



Part	Article-Nr.	A
397	39701	95
397	39702	100
397	39703	110

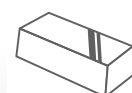
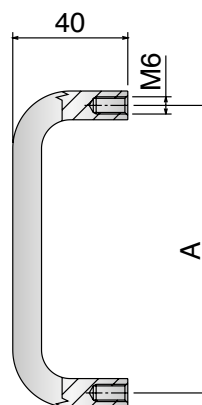
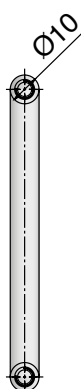

Stainless steel
AISI 304

Materiale / Material / Materialien:

Morsetti: Poliammide/Handels: Polyamide/Griff: Polyamid

Insero femmina: ottone nichelato/Female insert: Nickel plated brass/Einsatz: Messing vernickelt

Insero maschio: Acciaio inox/Male insert: Stainless steel/Aussengewinde: Edelstahl

374-375

Componenti / Conveyor components / Komponenten

374 Maniglia a ripresa Adjustable handle / Ratschenhebel



Part	Article-Nr.	A	B	C	D	E
374	37401	75	41	13	M8	11
374	37402	92	53	16	M10	16

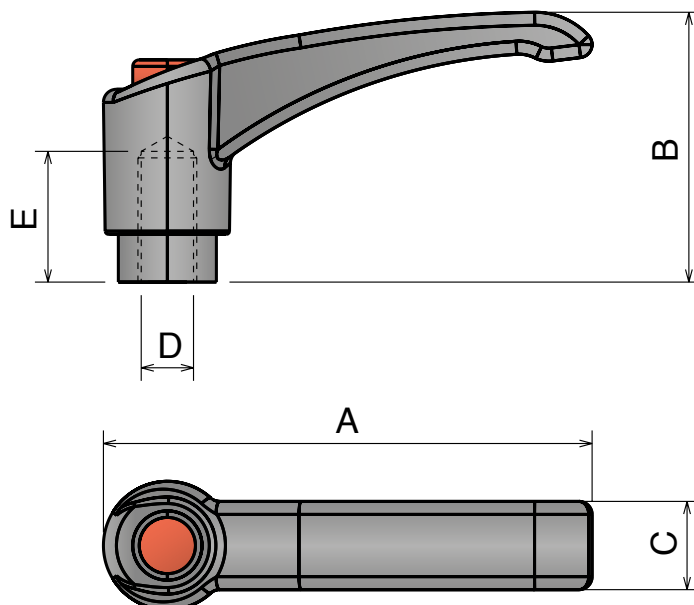

375 Maniglia a ripresa Adjustable handle / Ratschenhebel



Part	Article-Nr.	A	B	C	D	E
375	37501	75	41	13	M8	20
375	37502	92	53	16	M10	25

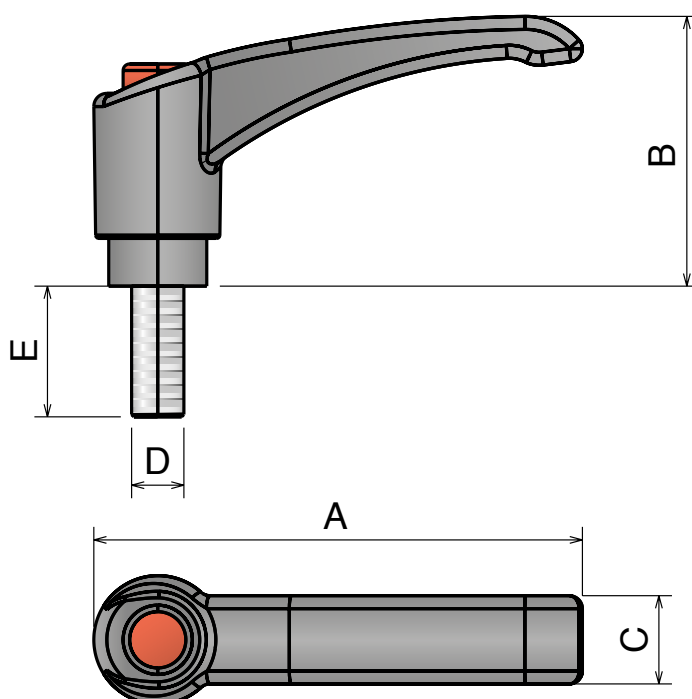

377

Morsetto standard per fotocellula o riflettore

Clamp for photocells or reflector / Klemme für Fotozelle oder Reflektor

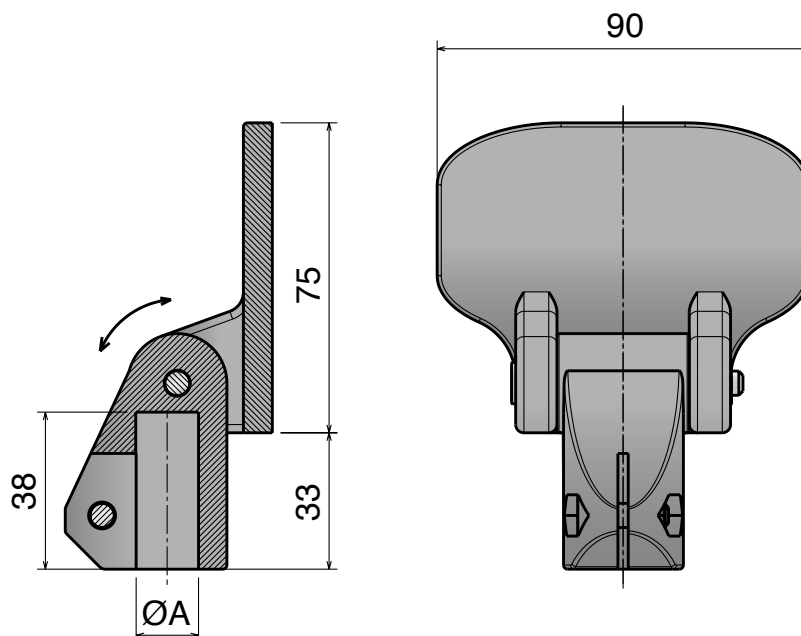

Part	Article-Nr.	ØA
377	37701	14
377	37702	16
377	37703	20

378

Morsetti "T"

T-clamp / T-Klemme

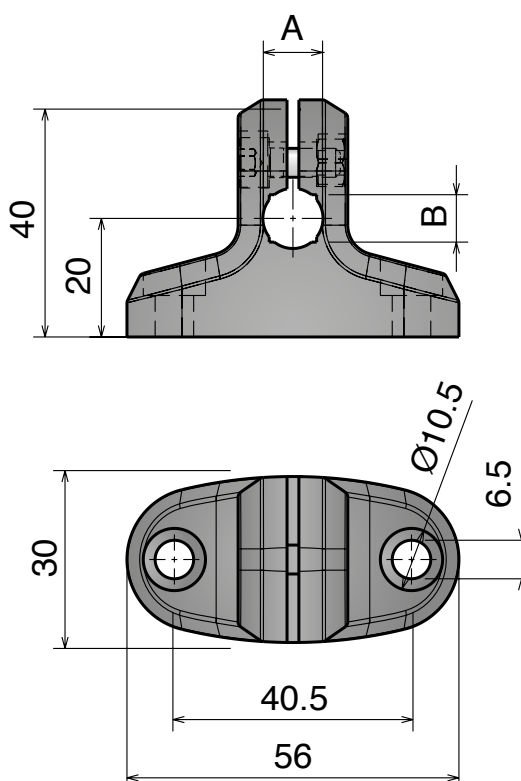

Part	Article-Nr.	A	B
378	37801	10	8
378	37802	12	10
378	37803	14	12

379

Morsetto per riflettore

Clamp for reflector / Reflektorklemme

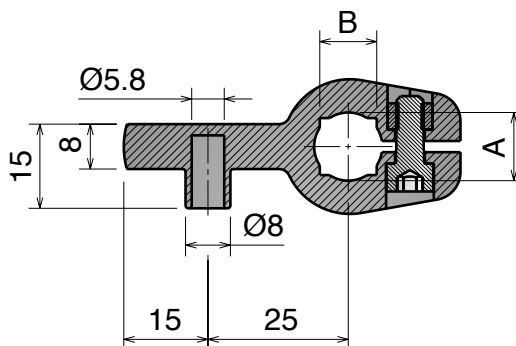
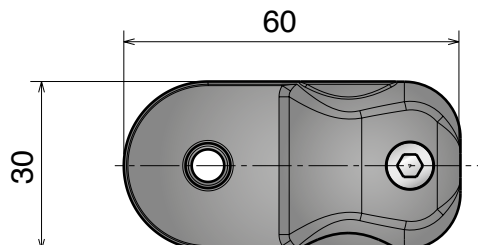

Part	Article-Nr.	A	B
379	37901	10	8
379	37902	12	10
379	37903	14	12

380

Morsetto per fotocellule o sensori

Clamp for photocells or sensors / Klemme für Lichtschränke oder Sensoren

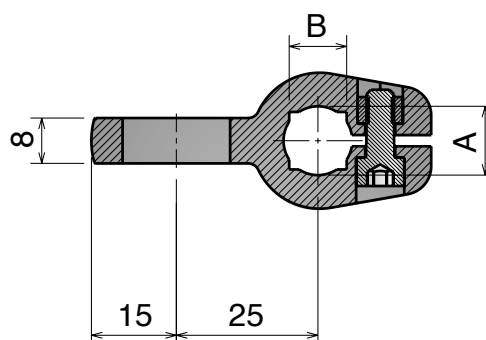
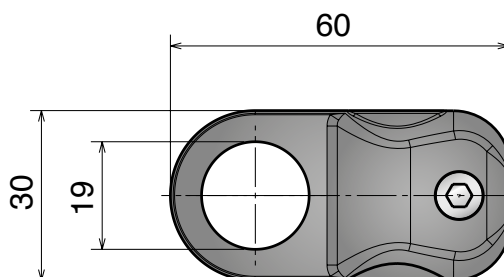

Part	Article-Nr.	A	B
380	38001	10	8
380	38002	12	10
380	38003	14	12

381

Morsetto a croce
Cross clamp / Kreuzklemmee

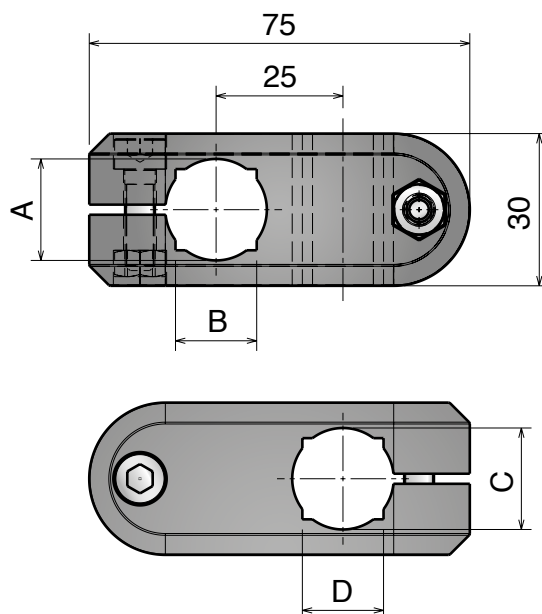

Part	Article-Nr.	A	B	C	D
381	38101	14	12	14	12
381	38102	16	14	16	14
381	38103	18	-	18	-
381	38104	20	16	20	16

382

Morsetto a croce
Cross clamp / Kreuzklemmee

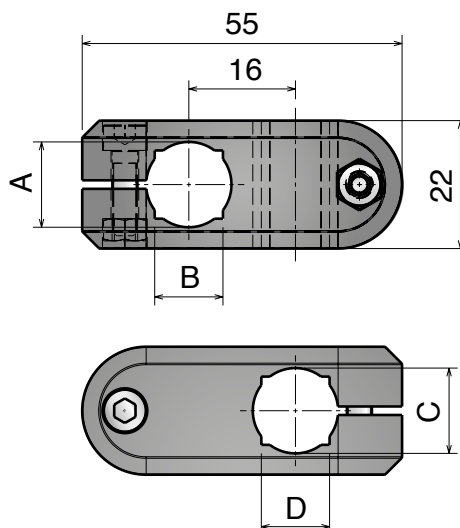

Part	Article-Nr.	A	B	C	D
382	38201	10	8	10	8
382	38202	12	10	12	10
382	38203	14	12	14	12

376 Morsetto a croce "extra" Extra Cross Block / Kreuzklemme "Extra"

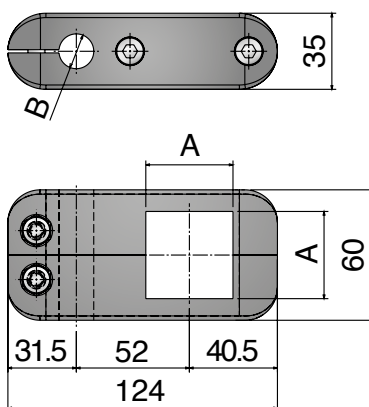

Part	Article-Nr.	A	B
376	37601	30x30	16
376	37602	40x40	16
376	37603	40x40	20

Morsetto a croce "extra" con maniglia Extra Cross Block with handle / Kreuzklemme "Extra" m. Ratschenhebel

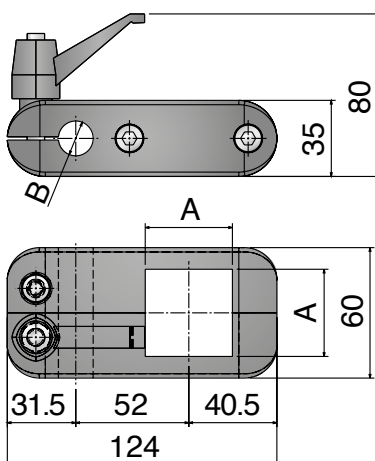

Part	Article-Nr.	A	B
376	37611	30x30	16
376	37612	40x40	16
376	37613	40x40	20

Morsetto a croce "extra" con maniglie Extra Cross Block with handles / Kreuzklemme "Extra" m. Ratschenhebel

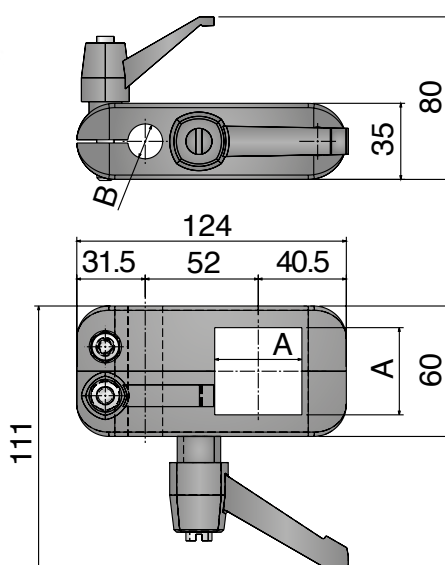

Part	Article-Nr.	A	B
376	37621	30x30	16
376	37622	40x40	16
376	37623	40x40	20

391

Morsetto a croce
Cross clamp / Kreuzklemmee



Part	Article-Nr.	ØA	ØB
391	39101	12	12
391	39103	14	14
391	39102	16	16
391	39104	12	16

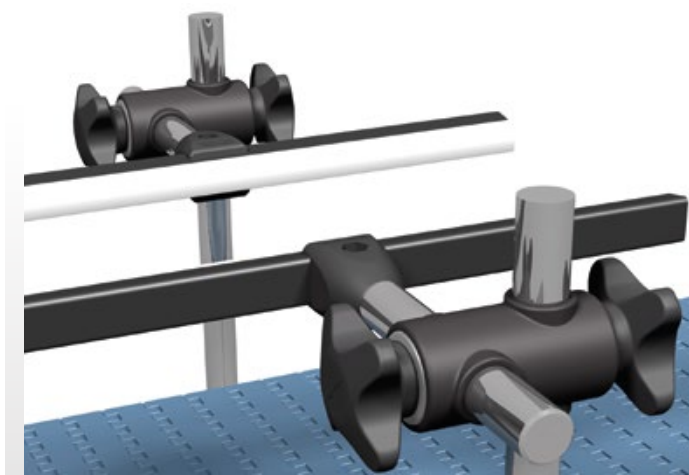
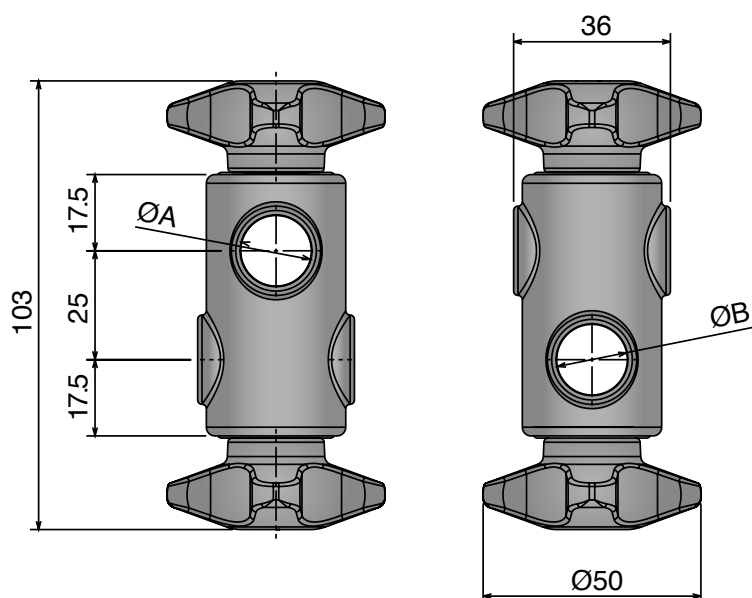

387 Sostegno per Sgocciolatoio Drip Tray Supports / Tropfblechhalter

Max load capacity 20 Kg

Part	Article-Nr.	L	Type
387	38701	180	A
387	38702	250	A
387	38703	180	B
387	38704	250	B
387	38705	280	B
387	38706	246	C
387	38707	396	C
387	38708	180	D
387	38709	250	D

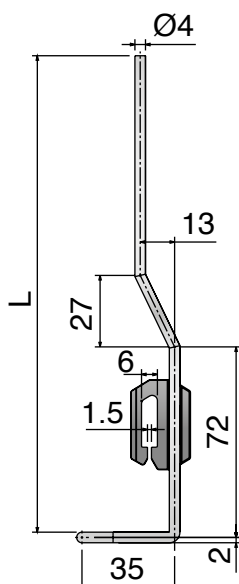
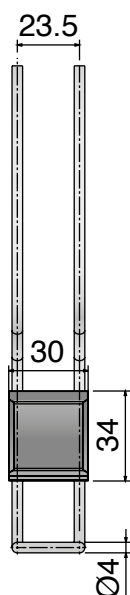

Type A

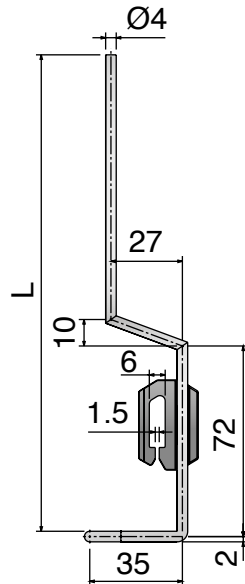

Type B

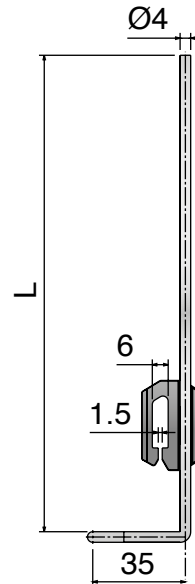

Type C

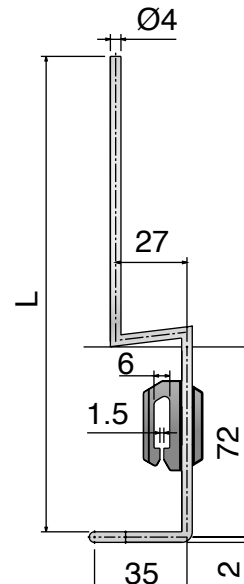

Type D

388 Rondella di fissaggio Fixing washer / Fixierscheibe

Part	Article-Nr.	Type
388	38801	A
388	38802	B

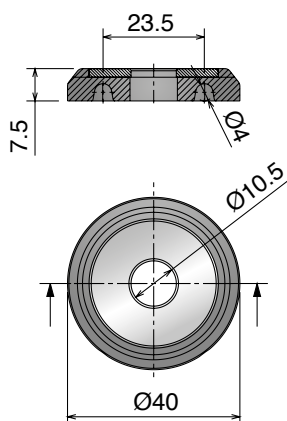

Type A

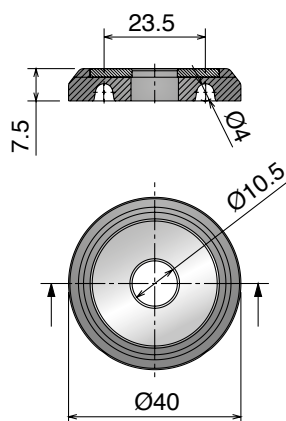

Type B



